

# Technická zpráva

## *Zaměření stávajícího stavu pro projekt*

**Název prací:** „Sil. III/42510 Rajhrad – OK Syrovice“

**Investor:** SÚSJMK, příspěvková organizace kraje

**Zadavatel:** Dopravoprojekt Ostrava a.s.

**Název lokality:** Sil. III/42510 Rajhrad – OK Syrovice

**Kraj:** Jihomoravský

**Okres:** Brno-venkov

**Katastrální území:** Rajhrad (738921), Holasice (640778)  
Vojkovice u Židlochovic (784567), Sobotovice (752142)

**Měřítko:** 1:5000/1000

**Číslo zakázky:** 2023033

**Souř. systém:** S-JTSK

**Výšk. systém:** Bpv

**Vypracoval:** Ing. Petr Hrbáč,  -geodetická kancelář

**ÚOZI:** Ing. Petr Hrbáč – položka seznamu ČUZK č. 2545/11

březen 2023

## 1. Použité přístroje:

- Totální stanice: TRIMBLE SPS 930(s.n.72613163), trojpodstavcová souprava
- GNSS stanice Trimble SPS986 (s.n. 6213F01100)
- Grafická linka: PC AT
- Plotter: Canon iPF605
- Tiskárna: CANON i-SENSYS MF735Cx

## 2. Použitý software:

- GEUS W 17.0
- MicroStation PowerMap 08.09.04.82
- Trimble Business Center v. 5.80

## 3. Údaje o použitých podkladech

Jako podklady pro geodetické měření sloužil snímek s vyznačením lokality a rekognoskace terénu na místě samém. Úkolem geodetických prací bylo zaměření stávajícího stavu a přilehlého okolí sil. III/42510 Rajhrad – OK Syrovice.

## 4. Přesnost měření

Charakteristikou přesnosti polohopisu a výškopisu je pro zpevněný povrch  $m_{xy}=0,03\text{m}$ ,  $m_h=0,03\text{m}$ , pro nezpevněný povrch  $m_{xy}=0,10\text{m}$ ,  $m_h=0,10\text{m}$  a pro vybrané objekty technické infrastruktury  $m_{xy}<0,03\text{m}$ ,  $m_h<0,015\text{m}$

## 5. Podrobné polohové a výškové bodové pole

Připojení na souřadnicový systém bylo provedeno GNSS aparaturou Trimble SPS986, která byla napojena na síť permanentních stanic pro určování polohy TRIMBLE VRS Now. Byl použit globální kalibrační klíč, ze kterého se zaměřily body 4001–4009 (viz příloha č.1). Byl použit souřadnicový systém S-JTSK a výškový systém Bpv.

2

## 6. Popis prací

Zaměření proběhlo dne 24-26. 03. 2023. Měření bylo provedeno polární metodou s kombinací GNSS RTK metodou. Měřil se stávající stav dané lokality, komunikace, svahy, propustky, viditelné inženýrské sítě atd. Z tohoto zaměření se vyhotovil polohopisný a výškopisný plán.

Zpracované zaměření v digitální podobě bylo předáno objednateli. Všechny výpočty jsou uloženy u zpracovatele.

V digitální podobě byly předány tyto soubory

- |                              |                                  |
|------------------------------|----------------------------------|
| – 2023033.dgn (dwg) .....    | zaměření, polohopis a výškopis   |
| – 2023033_km.dgn (dwg) ..... | digitální katastrální mapa       |
| – 2023033.xlsx, (txt) .....  | seznam souřadnic zaměřených bodů |
| – 2023033.pdf .....          | celkový elaborát                 |

Grafický elaborát obsahuje:

- technickou zprávu
- seznam souřadnic bodů PBPP
- seznam souřadnic měřených bodů
- celková situace (M 1:5000)
- situace č. 1-4 (M 1:1000) Polohopisný a výškopisný plán, soutisk s katastrální mapou

## 7. Zákony, normy, předpisy

- Zákon 200/1994 Sb. - Zeměměřický zákon
- Vyhláška 31/1995 – ČÚZK, kterou se provádí Zákon 200/1994 Sb.
- ČSN 01 3411 Mapy velkých měřítek: Kreslení a značky
- ČSN 73 0415 Geodetické body
- Vyhláška 30/2001 Sb., kterou se provádějí pravidla provozu na pozemních komunikacích a úprava a řízení provozu na pozemních komunikacích, ve znění pozdějších předpisů
- Vyhláška 104/1997 Sb., kterou se provádí zákon o pozemních komunikacích, ve znění pozdějších předpisů
- Zákon 13/1997 Sb. O pozemních komunikacích, ve znění pozdějších předpisů.

  
IGH - geodetická kancelář  
Ing. Petr Hrbáč  
756 51 Zašová 710  
IČ 69605343 DIČ CZ7510044135  
tel. +420 603 74 22 18

Vypracoval dne: 27. 03. 2023

Ing. Petr Hrbáč

## Příloha č.1: podrobné polohové a výškové bodové pole

3

| č.b. | Y         | X          | Z      | popis        |
|------|-----------|------------|--------|--------------|
| 4001 | 602866.80 | 1175339.21 | 231.42 | nastřel.hřeb |
| 4002 | 602765.38 | 1175216.14 | 231.45 | nastřel.hřeb |
| 4003 | 602642.60 | 1175053.97 | 229.79 | nastřel.hřeb |
| 4004 | 602381.62 | 1174738.73 | 225.83 | nastřel.hřeb |
| 4005 | 602220.93 | 1174531.47 | 224.64 | nastřel.hřeb |
| 4006 | 602018.72 | 1174268.66 | 222.81 | nastřel.hřeb |
| 4007 | 601722.35 | 1173894.87 | 221.20 | nastřel.hřeb |
| 4008 | 601491.57 | 1173603.03 | 225.00 | nastřel.hřeb |
| 4009 | 601273.98 | 1173342.23 | 225.62 | nastřel.hřeb |

| č.bodu | Y         | X          | Z      | popis     | č.bodu | Y         | X          | Z      | popis         |
|--------|-----------|------------|--------|-----------|--------|-----------|------------|--------|---------------|
| 1      | 602888.14 | 1175374.69 | 229.62 | XAC       | 84     | 602819.84 | 1175293.33 | 230.82 |               |
| 2      | 602887.33 | 1175374.91 | 229.53 | XNZP      | 85     | 602820.72 | 1175292.55 | 230.99 | NZP           |
| 3      | 602892.25 | 1175373.23 | 229.83 | XOSA      | 86     | 602821.79 | 1175291.30 | 230.96 | AC            |
| 4      | 602897.43 | 1175371.31 | 230.12 |           | 87     | 602819.44 | 1175288.80 | 230.97 | AC            |
| 5      | 602900.10 | 1175370.07 | 230.10 | XBET      | 88     | 602818.45 | 1175289.00 | 230.95 | NZP           |
| 6      | 602900.68 | 1175369.39 | 230.04 | XNZP1     | 89     | 602817.01 | 1175285.53 | 230.90 | NZP           |
| 7      | 602897.71 | 1175366.15 | 230.34 | NZP1      | 90     | 602819.00 | 1175288.48 | 230.96 | AC            |
| 8      | 602896.98 | 1175366.82 | 230.42 | BET       | 91     | 602817.54 | 1175285.25 | 230.96 | AC            |
| 9      | 602895.89 | 1175365.38 | 230.53 | BET       | 92     | 602815.67 | 1175282.04 | 230.98 | AC            |
| 10     | 602896.69 | 1175364.97 | 230.45 | NZP1      | 93     | 602815.04 | 1175281.13 | 230.99 | AC NZP        |
| 11     | 602894.83 | 1175361.81 | 230.67 | NZP1      | 94     | 602814.40 | 1175280.70 | 231.20 | XDUM XBZD     |
| 12     | 602893.98 | 1175362.07 | 230.77 | BET       | 95     | 602813.43 | 1175281.44 | 231.14 | DUM           |
| 13     | 602892.65 | 1175358.08 | 230.94 | NZP1 XHOR | 96     | 602811.70 | 1175279.10 | 231.17 | DUM           |
| 14     | 602892.05 | 1175358.48 | 230.95 | BET XNEJ  | 97     | 602812.67 | 1175278.48 | 231.20 | DUM BZD       |
| 15     | 602886.61 | 1175361.29 | 230.55 | NEJ OSA   | 98     | 602814.38 | 1175280.14 | 231.01 | AC            |
| 16     | 602884.91 | 1175367.72 | 230.06 | AC        | 99     | 602813.19 | 1175277.75 | 231.07 | AC            |
| 17     | 602884.03 | 1175368.12 | 229.96 | NZP       | 100    | 602812.78 | 1175275.69 | 231.12 | AC            |
| 18     | 602881.95 | 1175363.82 | 230.27 | NZP       | 101    | 602811.93 | 1175272.45 | 231.21 | AC            |
| 19     | 602882.76 | 1175363.31 | 230.30 | NEJ AC    | 102    | 602810.22 | 1175269.57 | 231.18 | AC            |
| 20     | 602878.64 | 1175356.66 | 230.65 | AC        | 103    | 602811.37 | 1175276.18 | 231.16 | ZNACKA        |
| 21     | 602877.65 | 1175355.69 | 230.71 | AC        | 104    | 602812.81 | 1175274.60 | 231.17 |               |
| 22     | 602875.70 | 1175356.03 | 230.53 |           | 105    | 602813.74 | 1175273.56 | 231.21 |               |
| 23     | 602881.60 | 1175352.66 | 231.02 | OSA       | 106    | 602815.39 | 1175278.75 | 231.13 |               |
| 24     | 602886.24 | 1175349.37 | 231.39 | BET       | 107    | 602817.16 | 1175277.78 | 231.21 |               |
| 25     | 602886.78 | 1175348.90 | 231.31 | HOR       | 108    | 602823.57 | 1175285.20 | 231.30 |               |
| 26     | 602879.52 | 1175339.36 | 231.56 | HOR       | 109    | 602821.89 | 1175287.15 | 231.23 |               |
| 27     | 602878.79 | 1175339.68 | 231.62 | BET       | 110    | 602827.56 | 1175294.21 | 231.20 |               |
| 28     | 602875.00 | 1175342.39 | 231.41 | OSA       | 111    | 602829.81 | 1175292.75 | 231.37 |               |
| 29     | 602870.76 | 1175344.89 | 231.21 | AC        | 112    | 602833.26 | 1175296.84 | 231.43 |               |
| 30     | 602868.74 | 1175345.62 | 230.97 |           | 113    | 602831.61 | 1175298.09 | 231.36 |               |
| 31     | 602860.34 | 1175333.64 | 231.27 |           | 114    | 602835.99 | 1175294.14 | 231.51 | OSA           |
| 32     | 602861.89 | 1175332.78 | 231.52 | AC        | 115    | 602828.54 | 1175285.14 | 231.42 | OSA           |
| 33     | 602865.13 | 1175329.44 | 231.66 | OSA       | 116    | 602819.60 | 1175274.38 | 231.30 | OSA           |
| 34     | 602867.87 | 1175326.44 | 231.70 | BET       | 117    | 602813.83 | 1175267.47 | 231.27 | OSA           |
| 35     | 602868.23 | 1175325.95 | 231.64 | HOR       | 118    | 602818.33 | 1175265.66 | 231.03 | XHOR          |
| 36     | 602856.27 | 1175311.08 | 231.55 | HOR       | 119    | 602811.28 | 1175275.26 | 231.10 | XVS           |
| 37     | 602855.63 | 1175311.43 | 231.67 | BET       | 120    | 602808.96 | 1175270.30 | 231.14 | VS            |
| 38     | 602852.49 | 1175313.79 | 231.67 | OSA       | 121    | 602801.64 | 1175260.78 | 231.15 | VS            |
| 39     | 602849.19 | 1175316.75 | 231.56 | AC        | 122    | 602801.93 | 1175259.56 | 231.20 | AC            |
| 40     | 602848.08 | 1175317.20 | 231.41 |           | 123    | 602804.80 | 1175257.12 | 231.26 | OSA           |
| 41     | 602847.02 | 1175318.00 | 231.02 |           | 124    | 602807.74 | 1175254.57 | 231.25 | BET           |
| 42     | 602840.39 | 1175309.45 | 230.97 |           | 125    | 602808.47 | 1175253.76 | 231.10 | HOR           |
| 43     | 602840.99 | 1175309.07 | 231.41 |           | 126    | 602796.55 | 1175239.43 | 231.14 | HOR           |
| 44     | 602842.08 | 1175308.38 | 231.51 | AC        | 127    | 602795.44 | 1175239.65 | 231.29 | BET           |
| 45     | 602845.28 | 1175305.53 | 231.61 | OSA       | 128    | 602792.63 | 1175241.98 | 231.32 | OSA           |
| 46     | 602848.43 | 1175302.99 | 231.60 | BET       | 129    | 602789.58 | 1175244.82 | 231.27 | AC            |
| 47     | 602849.00 | 1175302.41 | 231.46 | HOR       | 130    | 602788.93 | 1175245.28 | 231.22 | VS            |
| 48     | 602849.14 | 1175301.79 | 231.33 | ZNACKA    | 131    | 602778.05 | 1175232.19 | 231.26 | VS            |
| 49     | 602846.30 | 1175299.06 | 231.50 | HOR       | 132    | 602778.74 | 1175231.94 | 231.34 | AC            |
| 50     | 602845.61 | 1175297.88 | 231.45 | HOR       | 133    | 602781.87 | 1175229.55 | 231.36 | OSA           |
| 51     | 602846.07 | 1175295.05 | 231.45 | ZNACKA    | 134    | 602785.09 | 1175227.09 | 231.38 | BET           |
| 52     | 602845.58 | 1175299.37 | 231.53 | BET       | 135    | 602785.90 | 1175226.70 | 231.23 | HOR           |
| 53     | 602843.77 | 1175295.28 | 231.42 | BET       | 136    | 602787.86 | 1175226.91 | 230.58 | XDLN          |
| 54     | 602841.83 | 1175291.07 | 231.27 | BET       | 137    | 602783.83 | 1175222.61 | 230.96 | ZNACKA        |
| 55     | 602840.20 | 1175287.95 | 231.23 | BET       | 138    | 602782.52 | 1175222.46 | 231.32 | HOR           |
| 56     | 602837.61 | 1175283.78 | 231.05 | BET       | 139    | 602780.88 | 1175221.96 | 231.42 | BET           |
| 57     | 602834.93 | 1175280.53 | 230.99 | BET       | 140    | 602778.17 | 1175224.53 | 231.42 | OSA           |
| 58     | 602831.32 | 1175276.59 | 230.98 | BET       | 141    | 602775.07 | 1175227.37 | 231.36 | AC            |
| 59     | 602828.93 | 1175273.89 | 230.99 | BET       | 142    | 602774.31 | 1175227.64 | 231.31 | VS            |
| 60     | 602827.59 | 1175272.40 | 231.00 | BET       | 143    | 602776.98 | 1175232.94 | 230.52 | XSS           |
| 61     | 602825.01 | 1175270.30 | 231.02 | BET       | 144    | 602770.31 | 1175225.40 | 230.30 | SS XKKAN DN50 |
| 62     | 602821.99 | 1175268.56 | 231.12 | BET       | 145    | 602772.29 | 1175225.02 | 231.43 | VS XDUM XBZD  |
| 63     | 602818.67 | 1175266.95 | 231.15 | BET       | 146    | 602772.25 | 1175224.56 | 231.45 | DUM           |
| 64     | 602815.79 | 1175263.91 | 231.22 | BET       | 147    | 602770.37 | 1175224.65 | 231.36 | DUM           |
| 65     | 602819.62 | 1175265.73 | 230.87 | ZNACKA    | 148    | 602768.50 | 1175226.08 | 231.22 | DUM           |
| 66     | 602819.69 | 1175269.04 | 231.23 |           | 149    | 602768.77 | 1175226.53 | 231.22 | DUM           |
| 67     | 602824.92 | 1175275.33 | 231.30 |           | 150    | 602770.53 | 1175225.08 | 231.36 | DUM BZD       |
| 68     | 602831.21 | 1175282.83 | 231.36 |           | 151    | 602772.90 | 1175225.03 | 231.40 | AC XAC1       |
| 69     | 602838.82 | 1175292.03 | 231.49 |           | 152    | 602772.78 | 1175225.12 | 231.41 | AC1           |
| 70     | 602841.86 | 1175301.40 | 231.57 | OSA       | 153    | 602768.87 | 1175220.36 | 231.41 | AC1           |
| 71     | 602838.04 | 1175303.93 | 231.40 | AC        | 154    | 602768.98 | 1175220.37 | 231.40 | AC            |
| 72     | 602836.38 | 1175302.15 | 231.39 | AC XNZP   | 155    | 602770.17 | 1175224.60 | 231.32 | XCES          |
| 73     | 602831.61 | 1175298.45 | 231.39 | AC        | 156    | 602768.03 | 1175224.99 | 231.22 | CES           |
| 74     | 602831.94 | 1175299.95 | 231.30 | NZP       | 157    | 602765.11 | 1175225.80 | 231.07 | CES           |
| 75     | 602831.48 | 1175301.60 | 230.85 |           | 158    | 602762.12 | 1175222.67 | 231.09 | XCES          |
| 76     | 602826.77 | 1175297.88 | 230.81 |           | 159    | 602760.39 | 1175222.46 | 231.01 | ZNACKA        |
| 77     | 602827.15 | 1175297.22 | 231.08 |           | 160    | 602762.75 | 1175221.54 | 231.17 | CES           |
| 78     | 602827.69 | 1175296.95 | 231.12 | NZP       | 161    | 602763.35 | 1175219.84 | 231.24 | CES           |
| 79     | 602828.35 | 1175296.81 | 231.16 | AC        | 162    | 602764.17 | 1175218.25 | 231.32 | CES           |
| 80     | 602825.15 | 1175294.07 | 230.98 | AC        | 163    | 602764.51 | 1175217.70 | 231.37 | CES           |
| 81     | 602824.12 | 1175294.74 | 230.98 | NZP       | 164    | 602765.06 | 1175215.87 | 231.44 | CES AC1       |
| 82     | 602824.11 | 1175294.78 | 230.99 | NZP       | 165    | 602765.15 | 1175215.73 | 231.45 | AC AC1        |
| 83     | 602823.10 | 1175295.52 | 230.82 |           | 166    | 602764.95 | 1175215.80 | 231.52 | XDUM XBZD     |

| č.bodu | Y         | X          | Z      | popis        | č.bodu | Y         | X          | Z      | popis  |
|--------|-----------|------------|--------|--------------|--------|-----------|------------|--------|--------|
| 167    | 602764.57 | 1175215.66 | 231.52 | DUM          | 250    | 602679.57 | 1175112.55 | 231.00 | VS     |
| 168    | 602764.00 | 1175217.33 | 231.42 | DUM          | 251    | 602678.31 | 1175113.57 | 230.36 | SS     |
| 169    | 602762.31 | 1175218.83 | 231.31 | DUM          | 252    | 602665.53 | 1175097.72 | 230.00 | SS     |
| 170    | 602762.60 | 1175219.19 | 231.29 | DUM          | 253    | 602667.44 | 1175097.38 | 230.68 | VS     |
| 171    | 602764.39 | 1175217.54 | 231.42 | DUM BZD      | 254    | 602668.03 | 1175097.20 | 230.73 | AC     |
| 172    | 602763.53 | 1175217.55 | 230.47 | KKAN XSS     | 255    | 602671.16 | 1175094.99 | 230.76 | OSA    |
| 173    | 602775.86 | 1175221.94 | 231.45 | OSA          | 256    | 602674.17 | 1175092.51 | 230.68 | BET    |
| 174    | 602772.34 | 1175217.92 | 231.49 | OSA          | 257    | 602674.93 | 1175092.18 | 230.62 | HOR    |
| 175    | 602768.04 | 1175212.78 | 231.52 | OSA          | 258    | 602676.36 | 1175091.56 | 230.15 | DLN    |
| 176    | 602780.78 | 1175217.99 | 230.40 | DLN XKKAN 50 | 259    | 602677.34 | 1175094.41 | 230.46 | ZNACKA |
| 177    | 602779.69 | 1175220.27 | 231.47 | BET XBET1    | 260    | 602660.11 | 1175071.39 | 229.72 | DLN    |
| 178    | 602779.72 | 1175220.11 | 231.49 | BET1 XCES    | 261    | 602658.79 | 1175072.33 | 230.19 | HOR    |
| 179    | 602779.79 | 1175219.78 | 231.48 | CES          | 262    | 602658.24 | 1175072.83 | 230.26 | BET    |
| 180    | 602779.78 | 1175219.78 | 231.48 | CES          | 263    | 602655.50 | 1175075.37 | 230.32 | OSA    |
| 181    | 602780.03 | 1175217.82 | 231.38 | CES          | 264    | 602652.68 | 1175078.05 | 230.27 | AC     |
| 182    | 602780.28 | 1175215.89 | 231.28 | CES          | 265    | 602652.11 | 1175078.87 | 230.19 | VS     |
| 183    | 602781.43 | 1175214.31 | 231.19 | CES          | 266    | 602651.20 | 1175079.99 | 229.62 | SS     |
| 184    | 602776.23 | 1175215.94 | 231.52 | BET1         | 267    | 602632.46 | 1175057.29 | 229.00 | SS     |
| 185    | 602776.15 | 1175216.03 | 231.49 | BET          | 268    | 602634.02 | 1175056.76 | 229.69 | VS     |
| 186    | 602772.14 | 1175211.17 | 231.53 | BET          | 269    | 602634.67 | 1175056.25 | 229.72 | AC     |
| 187    | 602772.26 | 1175211.10 | 231.55 | BET1 XCES    | 270    | 602637.64 | 1175053.89 | 229.78 | OSA    |
| 188    | 602774.18 | 1175210.85 | 231.45 | CES          | 271    | 602640.53 | 1175051.47 | 229.70 | BET    |
| 189    | 602775.57 | 1175210.87 | 231.39 | CES          | 272    | 602641.16 | 1175051.04 | 229.67 | HOR    |
| 190    | 602777.84 | 1175210.41 | 231.22 | CES          | 273    | 602642.32 | 1175050.04 | 229.09 | DLN    |
| 191    | 602777.03 | 1175208.69 | 231.26 | ZNACKA       | 274    | 602624.53 | 1175028.55 | 228.54 | DLN    |
| 192    | 602782.78 | 1175215.92 | 231.04 | ZNACKA       | 275    | 602623.16 | 1175029.10 | 229.14 | HOR    |
| 193    | 602782.19 | 1175216.61 | 231.29 | XDUM XBZD    | 276    | 602622.78 | 1175029.71 | 229.20 | BET    |
| 194    | 602781.86 | 1175216.26 | 231.29 | DUM          | 277    | 602620.09 | 1175032.28 | 229.25 | OSA    |
| 195    | 602780.11 | 1175217.86 | 231.42 | DUM          | 278    | 602617.16 | 1175034.84 | 229.20 | AC     |
| 196    | 602779.89 | 1175219.83 | 231.52 | DUM          | 279    | 602616.62 | 1175035.49 | 229.12 | VS     |
| 197    | 602780.34 | 1175219.88 | 231.52 | DUM          | 280    | 602615.58 | 1175036.43 | 228.57 | SS     |
| 198    | 602780.51 | 1175218.12 | 231.41 | DUM BZD      | 281    | 602598.93 | 1175016.40 | 228.05 | SS     |
| 199    | 602775.99 | 1175209.30 | 231.40 | XDUM XBZD    | 282    | 602600.28 | 1175015.36 | 228.65 | VS     |
| 200    | 602775.70 | 1175208.95 | 231.39 | DUM          | 283    | 602600.90 | 1175014.70 | 228.72 | AC     |
| 201    | 602774.01 | 1175210.36 | 231.51 | DUM          | 284    | 602603.32 | 1175012.34 | 228.76 | OSA    |
| 202    | 602772.21 | 1175210.57 | 231.61 | DUM          | 285    | 602606.33 | 1175009.64 | 228.71 | BET    |
| 203    | 602772.31 | 1175211.06 | 231.62 | DUM          | 286    | 602607.10 | 1175009.28 | 228.65 | HOR    |
| 204    | 602774.16 | 1175210.82 | 231.50 | DUM BZD      | 287    | 602608.23 | 1175008.46 | 228.12 | DLN    |
| 205    | 602774.16 | 1175210.02 | 230.44 | KKAN XDLN    | 288    | 602590.41 | 1174985.80 | 227.53 | DLN    |
| 206    | 602771.60 | 1175210.56 | 231.55 | BET          | 289    | 602588.85 | 1174986.34 | 228.05 | HOR    |
| 207    | 602772.05 | 1175210.27 | 231.49 | XHOR         | 290    | 602588.20 | 1174986.99 | 228.11 | BET    |
| 208    | 602764.25 | 1175215.44 | 231.42 | XVS          | 291    | 602585.26 | 1174989.47 | 228.18 | OSA    |
| 209    | 602754.30 | 1175205.73 | 230.87 | SS           | 292    | 602582.67 | 1174992.00 | 228.15 | AC     |
| 210    | 602755.28 | 1175204.53 | 231.47 | VS           | 293    | 602582.07 | 1174992.73 | 228.10 | VS     |
| 211    | 602755.77 | 1175204.09 | 231.51 | AC           | 294    | 602580.89 | 1174993.84 | 227.60 | SS     |
| 212    | 602758.71 | 1175201.31 | 231.61 | OSA          | 295    | 602563.18 | 1174971.45 | 227.31 | SS     |
| 213    | 602761.52 | 1175198.52 | 231.62 | BET          | 296    | 602564.36 | 1174970.97 | 227.76 | VS     |
| 214    | 602762.01 | 1175197.97 | 231.54 | HOR          | 297    | 602565.16 | 1174970.42 | 227.81 | AC     |
| 215    | 602763.03 | 1175196.85 | 230.92 | DLN          | 298    | 602568.02 | 1174968.12 | 227.88 | OSA    |
| 216    | 602750.89 | 1175181.82 | 231.02 | DLN          | 299    | 602571.10 | 1174965.74 | 227.81 | BET    |
| 217    | 602749.38 | 1175182.33 | 231.61 | HOR          | 300    | 602571.88 | 1174965.37 | 227.78 | HOR    |
| 218    | 602748.72 | 1175182.75 | 231.68 | BET          | 301    | 602573.03 | 1174964.58 | 227.27 | DLN    |
| 219    | 602745.49 | 1175185.22 | 231.69 | OSA          | 302    | 602555.87 | 1174942.51 | 227.06 | DLN    |
| 220    | 602742.43 | 1175187.76 | 231.66 | AC           | 303    | 602554.52 | 1174943.22 | 227.51 | HOR    |
| 221    | 602741.70 | 1175187.95 | 231.65 | VS           | 304    | 602553.86 | 1174943.91 | 227.56 | BET    |
| 222    | 602740.41 | 1175188.55 | 230.99 | SS           | 305    | 602551.18 | 1174946.52 | 227.65 | OSA    |
| 223    | 602725.83 | 1175170.91 | 230.94 | SS           | 306    | 602548.36 | 1174949.21 | 227.61 | AC     |
| 224    | 602727.09 | 1175170.31 | 231.61 | VS           | 307    | 602547.54 | 1174949.93 | 227.48 | VS     |
| 225    | 602727.86 | 1175169.96 | 231.66 | AC           | 308    | 602546.57 | 1174950.91 | 226.91 | SS     |
| 226    | 602730.93 | 1175167.88 | 231.74 | OSA          | 309    | 602538.80 | 1174921.18 | 227.46 | DLN    |
| 227    | 602734.01 | 1175165.44 | 231.68 | BET          | 310    | 602537.46 | 1174921.71 | 227.81 | HOR    |
| 228    | 602734.64 | 1175165.07 | 231.66 | HOR          | 311    | 602536.64 | 1174922.04 | 227.89 | BET    |
| 229    | 602735.92 | 1175164.02 | 231.18 | DLN          | 312    | 602533.73 | 1174924.13 | 227.94 | OSA    |
| 230    | 602740.27 | 1175170.31 | 231.50 | ZNACKA       | 313    | 602530.55 | 1174926.38 | 227.93 | AC     |
| 231    | 602719.70 | 1175144.64 | 230.94 | DLN          | 314    | 602528.75 | 1174927.49 | 227.56 | SS     |
| 232    | 602718.39 | 1175144.93 | 231.51 | HOR          | 315    | 602529.69 | 1174926.92 | 227.90 | VS     |
| 233    | 602717.60 | 1175145.41 | 231.57 | BET          | 316    | 602511.84 | 1174904.69 | 227.71 | VS     |
| 234    | 602714.57 | 1175147.77 | 231.59 | OSA          | 317    | 602510.70 | 1174905.38 | 227.49 |        |
| 235    | 602711.48 | 1175150.08 | 231.50 | AC           | 318    | 602512.44 | 1174904.05 | 227.77 | AC     |
| 236    | 602710.59 | 1175150.52 | 231.42 | VS           | 319    | 602515.01 | 1174901.57 | 227.81 | OSA    |
| 237    | 602709.23 | 1175151.18 | 230.74 | SS           | 320    | 602517.99 | 1174898.84 | 227.75 | BET    |
| 238    | 602695.23 | 1175133.50 | 230.71 | SS           | 321    | 602518.51 | 1174898.17 | 227.66 | HOR    |
| 239    | 602696.27 | 1175132.87 | 231.26 | VS           | 322    | 602519.49 | 1174897.14 | 227.30 | DLN    |
| 240    | 602696.92 | 1175132.57 | 231.29 | AC           | 323    | 602502.78 | 1174876.29 | 227.25 | DLN    |
| 241    | 602699.84 | 1175130.04 | 231.36 | OSA          | 324    | 602501.52 | 1174876.60 | 227.57 | HOR    |
| 242    | 602702.76 | 1175127.59 | 231.32 | BET          | 325    | 602500.70 | 1174877.01 | 227.67 | BET    |
| 243    | 602703.44 | 1175127.00 | 231.26 | HOR          | 326    | 602497.57 | 1174879.20 | 227.71 | OSA    |
| 244    | 602704.65 | 1175125.90 | 230.71 | DLN          | 327    | 602494.56 | 1174881.57 | 227.62 | AC     |
| 245    | 602688.08 | 1175105.60 | 230.39 | DLN          | 328    | 602493.47 | 1174881.91 | 227.55 |        |
| 246    | 602686.58 | 1175106.15 | 230.94 | HOR          | 329    | 602492.01 | 1174882.50 | 227.40 |        |
| 247    | 602685.93 | 1175106.70 | 230.99 | BET          | 330    | 602474.11 | 1174859.67 | 227.23 |        |
| 248    | 602683.19 | 1175109.23 | 231.07 | OSA          | 331    | 602475.15 | 1174858.98 | 227.43 |        |
| 249    | 602680.30 | 1175111.96 | 231.08 | AC           | 332    | 602475.82 | 1174858.34 | 227.51 | AC     |

| č.bodu | Y         | X          | Z      | popis     | č.bodu | Y         | X          | Z      | popis       |
|--------|-----------|------------|--------|-----------|--------|-----------|------------|--------|-------------|
| 333    | 602478.37 | 1174855.27 | 227.57 | OSA       | 416    | 602299.03 | 1174628.74 | 225.14 | OSA         |
| 334    | 602481.37 | 1174852.65 | 227.51 | BET       | 417    | 602302.30 | 1174626.32 | 225.09 | BET         |
| 335    | 602482.12 | 1174852.00 | 227.41 | HOR       | 418    | 602302.95 | 1174625.88 | 225.01 | HOR         |
| 336    | 602483.09 | 1174851.14 | 227.01 | DLN       | 419    | 602304.22 | 1174625.08 | 224.48 | DLN         |
| 337    | 602465.19 | 1174829.97 | 227.15 | DLN       | 420    | 602296.57 | 1174615.47 | 224.52 | DLN         |
| 338    | 602464.24 | 1174829.84 | 227.28 | HOR       | 421    | 602293.85 | 1174611.40 | 224.34 | DLN         |
| 339    | 602463.82 | 1174830.59 | 227.34 | BET       | 422    | 602290.76 | 1174607.68 | 224.41 | DLN         |
| 340    | 602461.09 | 1174833.25 | 227.39 | OSA       | 423    | 602287.47 | 1174603.59 | 224.38 | DLN         |
| 341    | 602458.12 | 1174835.44 | 227.31 | AC        | 424    | 602283.49 | 1174598.25 | 224.42 | DLN         |
| 342    | 602457.26 | 1174835.80 | 227.22 |           | 425    | 602295.64 | 1174617.57 | 225.06 | BET XNZP    |
| 343    | 602455.29 | 1174837.00 | 226.90 |           | 426    | 602292.97 | 1174612.67 | 224.92 | NZP HOR     |
| 344    | 602437.50 | 1174814.79 | 226.65 |           | 427    | 602291.01 | 1174609.72 | 224.75 | NZP         |
| 345    | 602439.06 | 1174813.68 | 226.83 |           | 428    | 602288.60 | 1174606.80 | 224.74 | NZP         |
| 346    | 602439.90 | 1174812.86 | 226.92 | AC        | 429    | 602285.27 | 1174603.16 | 224.84 | NZP XHOR    |
| 347    | 602442.64 | 1174810.55 | 227.02 | OSA       | 430    | 602281.60 | 1174598.85 | 224.86 | HOR         |
| 348    | 602445.61 | 1174808.21 | 226.91 | BET       | 431    | 602287.82 | 1174607.63 | 225.01 | BET         |
| 349    | 602446.77 | 1174807.12 | 226.84 | HOR       | 432    | 602282.31 | 1174600.55 | 224.98 | BET NZP     |
| 350    | 602447.71 | 1174806.33 | 226.43 | DLN       | 433    | 602279.87 | 1174597.80 | 224.98 | BET         |
| 351    | 602429.84 | 1174783.82 | 226.13 | DLN       | 434    | 602292.16 | 1174619.31 | 225.10 | OSA         |
| 352    | 602428.46 | 1174784.51 | 226.64 | HOR       | 435    | 602289.14 | 1174621.92 | 225.09 | AC          |
| 353    | 602427.73 | 1174785.05 | 226.70 | BET       | 436    | 602288.63 | 1174622.51 | 225.12 | VS          |
| 354    | 602424.86 | 1174787.54 | 226.74 | OSA       | 437    | 602287.57 | 1174623.40 | 224.81 | SS          |
| 355    | 602421.99 | 1174790.25 | 226.67 | AC        | 438    | 602274.12 | 1174606.42 | 224.71 | SS          |
| 356    | 602420.10 | 1174790.53 | 226.50 | ZNACKA    | 439    | 602275.05 | 1174605.97 | 225.01 | VS          |
| 357    | 602417.91 | 1174792.19 | 225.95 | ZNACKA    | 440    | 602275.72 | 1174605.25 | 225.01 | AC          |
| 358    | 602403.57 | 1174769.14 | 226.46 |           | 441    | 602278.37 | 1174602.98 | 225.02 | OSA         |
| 359    | 602404.48 | 1174768.43 | 226.59 | AC        | 442    | 602263.34 | 1174583.50 | 224.94 | OSA         |
| 360    | 602407.34 | 1174766.09 | 226.61 | OSA       | 443    | 602266.17 | 1174580.80 | 224.91 | BET         |
| 361    | 602410.45 | 1174763.67 | 226.53 | BET       | 444    | 602267.07 | 1174580.03 | 224.78 | HOR         |
| 362    | 602411.47 | 1174763.11 | 226.43 | HOR       | 445    | 602267.96 | 1174579.35 | 224.44 | DLN         |
| 363    | 602412.94 | 1174761.93 | 225.87 | DLN       | 446    | 602260.15 | 1174585.32 | 224.90 | AC          |
| 364    | 602407.37 | 1174757.33 | 226.51 | HOR       | 447    | 602259.60 | 1174585.82 | 224.90 | VS          |
| 365    | 602408.03 | 1174756.28 | 225.94 | DLN       | 448    | 602258.42 | 1174586.91 | 224.51 | SS          |
| 366    | 602406.85 | 1174758.65 | 226.52 | BET XNZP  | 449    | 602243.03 | 1174568.03 | 224.42 | SS          |
| 367    | 602404.67 | 1174754.15 | 226.46 | NZP       | 450    | 602244.06 | 1174566.99 | 224.66 | VS          |
| 368    | 602403.78 | 1174754.76 | 226.53 | BET       | 451    | 602244.75 | 1174566.31 | 224.72 | AC XNEJ     |
| 369    | 602398.99 | 1174748.82 | 226.50 | BET       | 452    | 602247.72 | 1174563.95 | 224.80 | NEJ OSA     |
| 370    | 602402.65 | 1174750.75 | 226.38 | NZP HOR   | 453    | 602250.92 | 1174561.44 | 224.75 | NEJ BET     |
| 371    | 602403.74 | 1174749.89 | 225.86 | DLN       | 454    | 602252.04 | 1174560.79 | 224.62 | HOR         |
| 372    | 602398.96 | 1174746.00 | 226.22 | NZP XHOR  | 455    | 602253.54 | 1174559.75 | 224.16 | DLN         |
| 373    | 602393.11 | 1174740.16 | 226.30 | NZP       | 456    | 602250.82 | 1174559.02 | 224.68 | HOR         |
| 374    | 602392.63 | 1174740.70 | 226.38 | BET       | 457    | 602249.62 | 1174559.58 | 224.71 | BET         |
| 375    | 602393.18 | 1174739.11 | 226.18 | HOR       | 458    | 602248.06 | 1174556.93 | 224.71 | BET         |
| 376    | 602394.20 | 1174738.04 | 225.69 | DLN       | 459    | 602249.15 | 1174556.20 | 224.67 | HOR         |
| 377    | 602389.92 | 1174737.35 | 226.29 | BET NZP   | 460    | 602248.09 | 1174553.31 | 224.61 | HOR         |
| 378    | 602389.85 | 1174735.66 | 226.15 | HOR       | 461    | 602246.50 | 1174553.39 | 224.67 | BET         |
| 379    | 602400.06 | 1174756.44 | 226.58 | OSA       | 462    | 602245.33 | 1174549.90 | 224.63 | BET         |
| 380    | 602396.95 | 1174758.81 | 226.48 | AC        | 463    | 602246.73 | 1174549.34 | 224.58 | HOR         |
| 381    | 602396.33 | 1174759.29 | 226.39 |           | 464    | 602246.57 | 1174545.50 | 224.46 | HOR         |
| 382    | 602395.92 | 1174759.78 | 226.19 |           | 465    | 602244.93 | 1174546.14 | 224.65 | BET         |
| 383    | 602380.32 | 1174739.70 | 226.13 | ZNACKA    | 466    | 602244.54 | 1174542.80 | 224.63 | BET         |
| 384    | 602381.33 | 1174738.64 | 226.31 | AC        | 467    | 602244.61 | 1174541.02 | 224.63 | BET         |
| 385    | 602385.74 | 1174738.56 | 226.41 | OSA       | 468    | 602242.64 | 1174563.36 | 224.64 | AC          |
| 386    | 602363.53 | 1174719.66 | 225.86 |           | 469    | 602241.00 | 1174561.89 | 224.63 | AC          |
| 387    | 602365.14 | 1174718.53 | 226.06 | AC        | 470    | 602238.59 | 1174560.36 | 224.58 | AC          |
| 388    | 602368.23 | 1174716.36 | 226.15 | OSA       | 471    | 602236.08 | 1174558.77 | 224.55 | AC          |
| 389    | 602371.47 | 1174713.97 | 226.10 | BET       | 472    | 602235.21 | 1174558.37 | 224.54 | AC          |
| 390    | 602372.42 | 1174713.29 | 225.95 | HOR       | 473    | 602231.38 | 1174556.99 | 224.50 | AC          |
| 391    | 602373.48 | 1174712.40 | 225.48 | DLN       | 474    | 602240.94 | 1174555.90 | 224.81 | XCES XCHO   |
| 392    | 602356.15 | 1174689.96 | 225.15 | DLN       | 475    | 602241.05 | 1174555.84 | 224.82 | XCES1 XCHO1 |
| 393    | 602353.96 | 1174690.48 | 225.80 | HOR       | 476    | 602241.35 | 1174555.98 | 224.82 | CES1        |
| 394    | 602353.41 | 1174691.08 | 225.85 | BET       | 477    | 602241.36 | 1174556.09 | 224.80 | CES         |
| 395    | 602350.77 | 1174693.60 | 225.90 | OSA       | 478    | 602241.69 | 1174556.04 | 224.81 | CES         |
| 396    | 602347.76 | 1174696.13 | 225.89 | AC        | 479    | 602241.73 | 1174555.94 | 224.81 | CES1        |
| 397    | 602347.25 | 1174696.58 | 225.88 |           | 480    | 602241.98 | 1174555.79 | 224.82 | CES1        |
| 398    | 602346.17 | 1174698.12 | 225.63 |           | 481    | 602242.11 | 1174555.87 | 224.81 | CES         |
| 399    | 602331.73 | 1174675.48 | 225.29 | AC        | 482    | 602242.29 | 1174555.55 | 224.82 | CES         |
| 400    | 602330.95 | 1174675.85 | 225.25 | XVS       | 483    | 602242.16 | 1174555.52 | 224.82 | CES1        |
| 401    | 602329.62 | 1174676.23 | 224.95 | XSS       | 484    | 602242.14 | 1174555.08 | 224.82 | CES1        |
| 402    | 602334.22 | 1174673.31 | 225.32 | OSA       | 485    | 602242.29 | 1174555.04 | 224.81 | CES         |
| 403    | 602336.98 | 1174670.65 | 225.29 | BET       | 486    | 602241.26 | 1174551.85 | 224.82 | CES         |
| 404    | 602337.72 | 1174669.87 | 225.22 | HOR       | 487    | 602241.11 | 1174551.93 | 224.83 | CES1        |
| 405    | 602339.03 | 1174668.41 | 224.59 | DLN       | 488    | 602240.87 | 1174551.75 | 224.85 | CES1        |
| 406    | 602320.78 | 1174645.86 | 224.59 | DLN       | 489    | 602241.02 | 1174551.57 | 224.82 | CES         |
| 407    | 602319.36 | 1174646.71 | 225.13 | HOR       | 490    | 602240.47 | 1174551.48 | 224.82 | CES         |
| 408    | 602318.78 | 1174647.11 | 225.18 | BET       | 491    | 602240.40 | 1174551.74 | 224.84 | CES1        |
| 409    | 602315.50 | 1174649.16 | 225.23 | OSA       | 492    | 602240.14 | 1174551.82 | 224.84 | CES1        |
| 410    | 602312.62 | 1174651.30 | 225.22 | AC        | 493    | 602240.03 | 1174551.67 | 224.82 | CES         |
| 411    | 602311.95 | 1174651.74 | 225.24 | VS        | 494    | 602238.35 | 1174553.15 | 224.80 | CES         |
| 412    | 602310.40 | 1174652.55 | 224.85 | SS        | 495    | 602238.46 | 1174553.25 | 224.81 | CES1        |
| 413    | 602294.83 | 1174632.77 | 224.80 | SS ZNACKA | 496    | 602238.30 | 1174553.63 | 224.80 | CES1        |
| 414    | 602295.65 | 1174631.83 | 225.10 | VS        | 497    | 602238.17 | 1174553.63 | 224.78 | CES         |
| 415    | 602296.33 | 1174631.32 | 225.13 | AC        | 498    | 602238.21 | 1174554.12 | 224.77 | CES         |

| č.bodu | Y         | X          | Z      | popis       | č.bodu | Y         | X          | Z      | popis  |
|--------|-----------|------------|--------|-------------|--------|-----------|------------|--------|--------|
| 499    | 602238.35 | 1174554.04 | 224.79 | CES1        | 582    | 602151.46 | 1174451.07 | 223.68 | popis  |
| 500    | 602238.51 | 1174554.25 | 224.80 | CES1 CHO1   | 583    | 602150.18 | 1174451.40 | 223.52 | NZP    |
| 501    | 602238.41 | 1174554.32 | 224.78 | CES CHO     | 584    | 602150.57 | 1174447.15 | 223.83 | AC NZP |
| 502    | 602241.35 | 1174555.18 | 224.85 | ZNACKA      | 585    | 602165.85 | 1174460.70 | 224.03 | OSA    |
| 503    | 602236.79 | 1174560.83 | 224.61 | ZNACKA      | 586    | 602169.18 | 1174458.54 | 224.01 | BET    |
| 504    | 602215.17 | 1174525.51 | 224.34 | XCES1 XCHO1 | 587    | 602169.71 | 1174457.83 | 223.85 | HOR    |
| 505    | 602215.26 | 1174525.66 | 224.31 | XCES XCHO   | 588    | 602170.66 | 1174456.56 | 223.52 | DLN    |
| 506    | 602216.80 | 1174524.37 | 224.37 | CES         | 589    | 602156.98 | 1174439.29 | 223.34 | DLN    |
| 507    | 602216.71 | 1174524.31 | 224.38 | CES1        | 590    | 602155.83 | 1174440.08 | 223.81 | HOR    |
| 508    | 602216.93 | 1174524.01 | 224.39 | CES1        | 591    | 602155.02 | 1174440.55 | 223.83 | BET    |
| 509    | 602217.06 | 1174524.12 | 224.37 | CES         | 592    | 602152.21 | 1174442.66 | 223.83 | OSA    |
| 510    | 602217.16 | 1174523.67 | 224.38 | CES         | 593    | 602143.47 | 1174422.23 | 223.27 | DLN    |
| 511    | 602217.02 | 1174523.64 | 224.39 | CES1        | 594    | 602142.18 | 1174423.15 | 223.65 | HOR    |
| 512    | 602216.93 | 1174523.29 | 224.38 | CES1        | 595    | 602141.79 | 1174423.69 | 223.71 | BET    |
| 513    | 602217.06 | 1174523.23 | 224.37 | CES         | 596    | 602144.07 | 1174423.90 | 223.51 | ZNACKA |
| 514    | 602216.88 | 1174522.99 | 224.36 | CES         | 597    | 602139.29 | 1174426.72 | 223.75 | OSA    |
| 515    | 602216.82 | 1174523.10 | 224.38 | CES1        | 598    | 602136.40 | 1174429.00 | 223.71 | AC     |
| 516    | 602213.97 | 1174520.93 | 224.30 | CES1        | 599    | 602135.49 | 1174429.41 | 223.72 |        |
| 517    | 602214.04 | 1174520.83 | 224.29 | CES         | 600    | 602134.06 | 1174430.44 | 223.37 |        |
| 518    | 602213.61 | 1174520.77 | 224.29 | CES         | 601    | 602116.69 | 1174407.97 | 223.24 |        |
| 519    | 602213.59 | 1174520.90 | 224.30 | CES1        | 602    | 602117.69 | 1174407.10 | 223.48 |        |
| 520    | 602213.21 | 1174521.02 | 224.29 | CES1        | 603    | 602118.49 | 1174406.61 | 223.51 | AC     |
| 521    | 602213.13 | 1174520.87 | 224.28 | CES         | 604    | 602120.66 | 1174403.61 | 223.58 | OSA    |
| 522    | 602212.82 | 1174521.21 | 224.26 | CES         | 605    | 602123.73 | 1174400.91 | 223.52 | BET    |
| 523    | 602213.00 | 1174521.29 | 224.28 | CES1        | 606    | 602124.47 | 1174400.25 | 223.40 | HOR    |
| 524    | 602212.97 | 1174521.52 | 224.29 | CES1        | 607    | 602125.19 | 1174399.22 | 223.11 | DLN    |
| 525    | 602212.81 | 1174521.57 | 224.26 | CES         | 608    | 602106.47 | 1174375.19 | 222.89 | DLN    |
| 526    | 602214.10 | 1174525.35 | 224.28 | CES         | 609    | 602104.84 | 1174375.49 | 223.26 | HOR    |
| 527    | 602214.26 | 1174525.28 | 224.29 | CES1        | 610    | 602104.10 | 1174375.75 | 223.31 | BET    |
| 528    | 602214.50 | 1174525.48 | 224.30 | CES1        | 611    | 602100.84 | 1174378.12 | 223.37 | OSA    |
| 529    | 602214.47 | 1174525.63 | 224.29 | CES         | 612    | 602097.65 | 1174380.54 | 223.36 | AC     |
| 530    | 602214.96 | 1174525.72 | 224.31 | CES CHO     | 613    | 602097.02 | 1174381.08 | 223.32 | XVS    |
| 531    | 602214.92 | 1174525.61 | 224.32 | CES1 CHO1   | 614    | 602095.98 | 1174381.93 | 222.93 |        |
| 532    | 602209.79 | 1174529.89 | 224.08 | XAC         | 615    | 602078.47 | 1174359.43 | 222.94 |        |
| 533    | 602209.48 | 1174527.30 | 224.09 | AC          | 616    | 602079.31 | 1174358.97 | 223.13 | VS     |
| 534    | 602207.90 | 1174522.06 | 224.10 | AC          | 617    | 602080.22 | 1174358.44 | 223.18 | AC     |
| 535    | 602206.47 | 1174518.20 | 224.12 | AC          | 618    | 602082.81 | 1174356.02 | 223.20 | OSA    |
| 536    | 602204.81 | 1174515.42 | 224.15 | AC          | 619    | 602085.99 | 1174353.41 | 223.10 | BET    |
| 537    | 602201.49 | 1174510.92 | 224.18 | AC XNEJ     | 620    | 602086.83 | 1174352.86 | 223.02 | HOR    |
| 538    | 602200.64 | 1174512.13 | 224.09 |             | 621    | 602087.50 | 1174351.85 | 222.55 | DLN    |
| 539    | 602202.37 | 1174515.26 | 223.99 |             | 622    | 602071.17 | 1174331.23 | 222.55 | DLN    |
| 540    | 602204.18 | 1174518.31 | 223.89 |             | 623    | 602070.05 | 1174331.85 | 222.93 | HOR    |
| 541    | 602205.68 | 1174522.67 | 223.92 |             | 624    | 602069.33 | 1174332.33 | 223.03 | BET    |
| 542    | 602223.89 | 1174521.13 | 224.31 | XBET        | 625    | 602072.96 | 1174333.87 | 222.80 | ZNACKA |
| 543    | 602221.27 | 1174519.93 | 224.24 | BET         | 626    | 602067.44 | 1174336.00 | 223.10 | OSA    |
| 544    | 602219.14 | 1174518.57 | 224.11 | BET         | 627    | 602064.72 | 1174338.65 | 223.05 | AC     |
| 545    | 602216.89 | 1174516.94 | 224.12 | BET         | 628    | 602064.04 | 1174339.19 | 222.98 | VS     |
| 546    | 602214.21 | 1174514.73 | 224.22 | BET         | 629    | 602063.10 | 1174340.06 | 222.64 |        |
| 547    | 602211.94 | 1174512.06 | 224.20 | BET         | 630    | 602045.65 | 1174317.73 | 222.55 |        |
| 548    | 602210.81 | 1174517.18 | 224.24 | XOSA        | 631    | 602046.36 | 1174317.43 | 222.83 | VS     |
| 549    | 602207.34 | 1174512.60 | 224.22 | OSA         | 632    | 602047.01 | 1174316.94 | 222.90 | AC     |
| 550    | 602204.28 | 1174508.65 | 224.23 | OSA NEJ     | 633    | 602049.74 | 1174314.69 | 222.95 | OSA    |
| 551    | 602207.05 | 1174506.26 | 224.26 | NEJ BET     | 634    | 602052.87 | 1174312.11 | 222.87 | BET    |
| 552    | 602218.79 | 1174516.66 | 224.20 | ZNACKA      | 635    | 602053.74 | 1174311.52 | 222.78 | HOR    |
| 553    | 602213.58 | 1174521.31 | 224.32 | ZNACKA      | 636    | 602054.81 | 1174310.61 | 222.25 | DLN    |
| 554    | 602216.73 | 1174511.46 | 224.07 | NIVZN       | 637    | 602038.41 | 1174289.28 | 222.29 | DLN    |
| 555    | 602212.58 | 1174511.25 | 224.12 | XHOR        | 638    | 602036.92 | 1174290.17 | 222.80 | HOR    |
| 556    | 602213.42 | 1174509.84 | 223.67 | XDLN        | 639    | 602036.25 | 1174290.56 | 222.84 | BET    |
| 557    | 602188.88 | 1174500.00 | 223.67 |             | 640    | 602033.01 | 1174292.99 | 222.91 | OSA    |
| 558    | 602190.50 | 1174498.56 | 224.17 | VS          | 641    | 602030.31 | 1174295.64 | 222.83 | AC     |
| 559    | 602191.23 | 1174497.86 | 224.20 | AC          | 642    | 602029.63 | 1174296.29 | 222.77 | VS     |
| 560    | 602193.67 | 1174495.51 | 224.20 | OSA         | 643    | 602028.86 | 1174297.47 | 222.35 |        |
| 561    | 602196.39 | 1174492.65 | 224.17 | BET         | 644    | 602011.70 | 1174275.29 | 222.50 |        |
| 562    | 602196.85 | 1174492.29 | 224.18 | HOR         | 645    | 602012.56 | 1174274.81 | 222.78 | VS     |
| 563    | 602198.22 | 1174490.67 | 223.61 | DLN         | 646    | 602013.04 | 1174274.11 | 222.82 | AC     |
| 564    | 602182.05 | 1174470.75 | 223.60 | DLN         | 647    | 602015.95 | 1174271.63 | 222.84 | OSA    |
| 565    | 602180.61 | 1174471.44 | 223.99 | HOR         | 648    | 602019.28 | 1174269.23 | 222.81 | BET    |
| 566    | 602179.95 | 1174471.65 | 224.04 | BET         | 649    | 602019.90 | 1174269.09 | 222.77 | HOR    |
| 567    | 602176.83 | 1174473.86 | 224.08 | OSA         | 650    | 602021.32 | 1174267.86 | 222.21 | DLN    |
| 568    | 602173.85 | 1174476.16 | 224.07 | AC          | 651    | 602022.02 | 1174266.19 | 222.36 | ZNACKA |
| 569    | 602172.88 | 1174476.60 | 224.05 | VS          | 652    | 602020.02 | 1174267.69 | 222.41 | ZNACKA |
| 570    | 602171.68 | 1174477.08 | 223.64 |             | 653    | 602004.05 | 1174246.10 | 222.19 |        |
| 571    | 602172.12 | 1174473.95 | 224.05 | AC XNZP     | 654    | 602002.77 | 1174246.99 | 222.70 | HOR    |
| 572    | 602168.51 | 1174471.11 | 224.01 | NZP VS      | 655    | 602002.18 | 1174247.57 | 222.69 | BET    |
| 573    | 602166.68 | 1174471.69 | 223.73 |             | 656    | 601999.00 | 1174250.00 | 222.75 | OSA    |
| 574    | 602169.05 | 1174470.03 | 223.99 | AC          | 657    | 601996.17 | 1174252.19 | 222.67 | AC     |
| 575    | 602163.58 | 1174463.67 | 223.96 | AC          | 658    | 601995.18 | 1174252.74 | 222.66 | VS     |
| 576    | 602162.13 | 1174464.74 | 223.75 | NZP         | 659    | 601994.28 | 1174253.45 | 222.23 |        |
| 577    | 602160.76 | 1174465.54 | 223.50 |             | 660    | 601977.74 | 1174232.62 | 222.03 |        |
| 578    | 602155.89 | 1174458.74 | 223.59 |             | 661    | 601978.61 | 1174232.12 | 222.30 | VS     |
| 579    | 602156.10 | 1174457.71 | 223.63 | NZP         | 662    | 601979.44 | 1174231.48 | 222.34 | AC     |
| 580    | 602157.65 | 1174456.16 | 223.88 | AC          | 663    | 601982.28 | 1174229.08 | 222.38 | OSA    |
| 581    | 602152.99 | 1174450.25 | 223.85 | AC          | 664    | 601985.48 | 1174226.33 | 222.29 | BET    |

| č.bodu | Y         | X          | Z      | popis     | č.bodu | Y         | X          | Z      | popis        |
|--------|-----------|------------|--------|-----------|--------|-----------|------------|--------|--------------|
| 665    | 601986.10 | 1174226.01 | 222.22 | HOR       | 748    | 601592.24 | 1173736.55 | 223.64 | OSA          |
| 666    | 601987.38 | 1174225.11 | 221.75 | DLN       | 749    | 601595.41 | 1173734.21 | 223.58 | BET          |
| 667    | 601969.04 | 1174201.79 | 221.26 | DLN       | 750    | 601601.86 | 1173740.48 | 223.46 | HOR          |
| 668    | 601967.71 | 1174202.65 | 221.80 | HOR       | 751    | 601602.40 | 1173739.72 | 223.37 | HOR          |
| 669    | 601966.93 | 1174203.27 | 221.83 | BET XNEJ  | 752    | 601603.49 | 1173739.04 | 223.22 | HOR          |
| 670    | 601964.02 | 1174205.74 | 221.88 | OSA NEJ   | 753    | 601605.15 | 1173741.20 | 223.27 | HOR          |
| 671    | 601961.17 | 1174208.08 | 221.83 | AC NEJ    | 754    | 601602.64 | 1173739.89 | 222.99 | DLN XKKAN    |
| 672    | 601960.36 | 1174208.78 | 221.80 | VS        | 755    | 601596.78 | 1173732.53 | 223.17 | KKAN 40 XDLN |
| 673    | 601959.26 | 1174209.83 | 221.52 |           | 756    | 601596.51 | 1173730.12 | 223.35 | XHOR         |
| 674    | 601951.69 | 1174199.66 | 221.12 |           | 757    | 601597.79 | 1173732.00 | 223.39 | HOR          |
| 675    | 601952.61 | 1174199.09 | 221.55 | VS        | 758    | 601596.18 | 1173733.27 | 223.52 | HOR          |
| 676    | 601953.50 | 1174198.62 | 221.66 | AC        | 759    | 601593.35 | 1173729.74 | 223.42 | HOR          |
| 677    | 601956.44 | 1174196.43 | 221.71 | OSA       | 760    | 601581.90 | 1173715.41 | 223.47 | HOR          |
| 678    | 601959.59 | 1174194.14 | 221.66 | BET       | 761    | 601582.54 | 1173714.56 | 223.12 | DLN          |
| 679    | 601965.32 | 1174200.08 | 221.65 | HOR XSVOD | 762    | 601580.73 | 1173715.44 | 223.60 | BET          |
| 680    | 601960.45 | 1174194.09 | 221.49 | SVOD      | 763    | 601577.91 | 1173718.22 | 223.65 | OSA          |
| 681    | 601951.89 | 1174183.46 | 221.49 | SVOD      | 764    | 601575.10 | 1173721.00 | 223.61 | AC           |
| 682    | 601951.33 | 1174183.70 | 221.54 | BET       | 765    | 601574.43 | 1173721.46 | 223.57 |              |
| 683    | 601948.55 | 1174186.07 | 221.61 | OSA       | 766    | 601573.00 | 1173722.70 | 223.20 |              |
| 684    | 601945.59 | 1174188.50 | 221.53 | AC        | 767    | 601556.73 | 1173701.36 | 223.49 |              |
| 685    | 601945.00 | 1174189.60 | 221.38 | VS        | 768    | 601557.73 | 1173700.80 | 223.79 |              |
| 686    | 601733.54 | 1173907.73 | 220.86 | XSVOD     | 769    | 601558.44 | 1173700.19 | 223.84 | AC           |
| 687    | 601732.82 | 1173907.91 | 220.93 | XBET      | 770    | 601561.23 | 1173697.78 | 223.91 | OSA          |
| 688    | 601730.06 | 1173910.51 | 220.99 | XOSA      | 771    | 601564.32 | 1173695.36 | 223.80 | BET          |
| 689    | 601727.29 | 1173913.09 | 220.92 | XAC       | 772    | 601565.08 | 1173694.85 | 223.82 | HOR          |
| 690    | 601726.43 | 1173913.83 | 220.80 | XVS       | 773    | 601566.12 | 1173693.83 | 223.26 | DLN          |
| 691    | 601720.03 | 1173905.90 | 220.93 | VS        | 774    | 601549.26 | 1173672.15 | 223.46 | DLN          |
| 692    | 601721.02 | 1173905.14 | 221.05 | AC        | 775    | 601547.89 | 1173672.97 | 224.10 | HOR          |
| 693    | 601723.71 | 1173902.55 | 221.12 | OSA       | 776    | 601547.47 | 1173673.54 | 224.13 | BET          |
| 694    | 601726.76 | 1173900.30 | 221.09 | BET       | 777    | 601544.46 | 1173676.26 | 224.16 | OSA          |
| 695    | 601728.17 | 1173900.92 | 220.97 | SVOD      | 778    | 601541.47 | 1173678.57 | 224.10 | AC           |
| 696    | 601723.46 | 1173895.03 | 221.10 | SVOD XHOR | 779    | 601540.73 | 1173679.18 | 224.05 |              |
| 697    | 601724.90 | 1173893.54 | 220.36 | XDLN      | 780    | 601539.55 | 1173680.25 | 223.66 |              |
| 698    | 601722.38 | 1173894.79 | 221.18 | BET XNEJ  | 781    | 601526.15 | 1173663.64 | 223.94 |              |
| 699    | 601719.43 | 1173897.01 | 221.23 | OSA NEJ   | 782    | 601527.48 | 1173663.29 | 224.31 |              |
| 700    | 601716.64 | 1173899.39 | 221.16 | AC NEJ    | 783    | 601528.55 | 1173662.54 | 224.36 | AC           |
| 701    | 601715.62 | 1173899.97 | 221.03 | VS        | 784    | 601531.60 | 1173660.23 | 224.42 | OSA          |
| 702    | 601714.24 | 1173900.75 | 220.31 |           | 785    | 601534.99 | 1173657.77 | 224.35 | BET          |
| 703    | 601698.20 | 1173880.65 | 221.15 |           | 786    | 601535.52 | 1173657.53 | 224.32 | HOR          |
| 704    | 601699.66 | 1173879.38 | 221.64 | VS        | 787    | 601536.77 | 1173656.54 | 223.82 | DLN          |
| 705    | 601700.22 | 1173878.94 | 221.64 | AC        | 788    | 600272.58 | 1171943.14 | 217.47 | XAC          |
| 706    | 601702.74 | 1173876.14 | 221.76 | OSA       | 789    | 600272.31 | 1171943.39 | 217.53 | XVS          |
| 707    | 601706.01 | 1173873.37 | 221.70 | BET       | 790    | 600271.24 | 1171944.20 | 217.05 | XSS          |
| 708    | 601706.49 | 1173872.72 | 221.60 | HOR       | 791    | 600275.54 | 1171941.30 | 217.55 |              |
| 709    | 601707.28 | 1173871.82 | 220.99 | DLN       | 792    | 600279.00 | 1171939.82 | 217.54 | XBET         |
| 710    | 601689.21 | 1173849.34 | 221.67 | DLN       | 793    | 600279.56 | 1171939.84 | 217.62 | XHOR         |
| 711    | 601688.01 | 1173849.76 | 222.17 | HOR       | 794    | 600280.73 | 1171939.11 | 217.14 | XDLN         |
| 712    | 601687.19 | 1173850.17 | 222.23 | BET       | 795    | 600285.81 | 1171947.02 | 217.31 | DLN          |
| 713    | 601684.38 | 1173852.41 | 222.27 | OSA       | 796    | 600284.43 | 1171947.04 | 217.69 | HOR          |
| 714    | 601680.96 | 1173854.64 | 222.23 | AC        | 797    | 600284.07 | 1171947.53 | 217.64 | BET XNEJ     |
| 715    | 601679.68 | 1173854.84 | 222.20 |           | 798    | 600280.89 | 1171949.56 | 217.66 | NEJ          |
| 716    | 601678.42 | 1173855.74 | 221.75 |           | 799    | 600280.93 | 1171949.69 | 217.66 | NEJ          |
| 717    | 601660.08 | 1173833.36 | 222.18 |           | 800    | 600278.00 | 1171951.53 | 217.61 | NEJ AC       |
| 718    | 601661.36 | 1173831.88 | 222.47 |           | 801    | 600277.48 | 1171952.01 | 217.69 | VS           |
| 719    | 601662.06 | 1173830.94 | 222.61 | AC        | 802    | 600276.92 | 1171952.56 | 217.33 | SS           |
| 720    | 601665.05 | 1173828.59 | 222.69 | OSA       | 803    | 600288.39 | 1171970.03 | 217.75 | SS           |
| 721    | 601668.00 | 1173826.17 | 222.67 | BET       | 804    | 600289.01 | 1171970.12 | 217.88 | VS           |
| 722    | 601668.77 | 1173825.51 | 222.63 | HOR       | 805    | 600289.65 | 1171969.63 | 217.87 | AC           |
| 723    | 601669.78 | 1173824.85 | 222.10 | DLN       | 806    | 600292.55 | 1171967.89 | 217.89 |              |
| 724    | 601652.74 | 1173802.90 | 222.52 | DLN       | 807    | 600295.94 | 1171966.12 | 217.89 | BET          |
| 725    | 601651.33 | 1173803.33 | 223.08 | HOR       | 808    | 600296.58 | 1171965.94 | 217.91 | HOR          |
| 726    | 601650.28 | 1173803.74 | 223.13 | BET       | 809    | 600297.85 | 1171965.21 | 217.47 | DLN          |
| 727    | 601647.57 | 1173805.70 | 223.19 | OSA       | 810    | 600299.09 | 1171968.39 | 217.87 | ZNACKA       |
| 728    | 601644.28 | 1173807.85 | 223.14 | AC        | 811    | 600305.82 | 1171977.49 | 217.72 | DLN          |
| 729    | 601643.22 | 1173808.30 | 223.06 |           | 812    | 600304.98 | 1171978.80 | 218.08 | HOR          |
| 730    | 601641.71 | 1173809.17 | 222.70 |           | 813    | 600304.28 | 1171979.10 | 218.07 | BET          |
| 731    | 601624.43 | 1173786.77 | 222.93 |           | 814    | 600301.12 | 1171981.21 | 218.09 |              |
| 732    | 601625.40 | 1173786.37 | 223.30 |           | 815    | 600297.92 | 1171982.74 | 218.04 | AC XNZP      |
| 733    | 601626.23 | 1173785.33 | 223.41 | AC        | 816    | 600297.23 | 1171983.02 | 218.06 | VS           |
| 734    | 601629.10 | 1173782.75 | 223.43 | OSA       | 817    | 600296.79 | 1171983.42 | 217.92 | SS           |
| 735    | 601631.99 | 1173780.30 | 223.38 | BET       | 818    | 600301.74 | 1171991.54 | 218.10 | VS SS NZP    |
| 736    | 601632.56 | 1173779.94 | 223.33 | HOR       | 819    | 600306.33 | 1171999.45 | 218.28 | NZP          |
| 737    | 601633.20 | 1173779.22 | 222.93 | DLN       | 820    | 600306.87 | 1172002.71 | 218.07 | NZP          |
| 738    | 601615.45 | 1173755.96 | 222.91 | DLN       | 821    | 600308.66 | 1172006.40 | 218.00 | NZP          |
| 739    | 601614.32 | 1173756.65 | 223.43 | HOR       | 822    | 600307.09 | 1171997.18 | 218.21 | AC           |
| 740    | 601613.53 | 1173757.16 | 223.48 | BET       | 823    | 600310.38 | 1171995.53 | 218.27 |              |
| 741    | 601610.54 | 1173759.33 | 223.54 | OSA       | 824    | 600313.74 | 1171993.73 | 218.24 | BET          |
| 742    | 601607.47 | 1173761.56 | 223.47 | AC        | 825    | 600314.42 | 1171993.42 | 218.25 | HOR          |
| 743    | 601606.54 | 1173761.95 | 223.43 |           | 826    | 600315.82 | 1171992.37 | 217.63 | DLN          |
| 744    | 601605.06 | 1173762.79 | 222.88 |           | 827    | 600328.20 | 1172010.31 | 217.85 |              |
| 745    | 601586.69 | 1173740.88 | 223.27 |           | 828    | 600326.79 | 1172011.65 | 218.36 | HOR          |
| 746    | 601588.24 | 1173739.53 | 223.53 |           | 829    | 600325.52 | 1172012.24 | 218.40 | BET          |
| 747    | 601589.22 | 1173738.80 | 223.56 | AC        | 830    | 600322.77 | 1172014.91 | 218.46 |              |



| č.bodu | Y         | X          | Z      | popis    | č.bodu | Y         | X          | Z      | popis   |
|--------|-----------|------------|--------|----------|--------|-----------|------------|--------|---------|
| 831    | 600319.64 | 1172017.14 | 218.36 | AC NZP   | 914    | 600390.37 | 1172120.53 | 221.75 |         |
| 832    | 600317.64 | 1172016.93 | 218.19 | XVS      | 915    | 600384.42 | 1172111.32 | 221.18 |         |
| 833    | 600331.04 | 1172015.93 | 218.34 | HOR      | 916    | 600378.33 | 1172101.77 | 220.75 |         |
| 834    | 600335.38 | 1172022.30 | 218.29 | HOR      | 917    | 600381.18 | 1172098.93 | 220.69 | BET     |
| 835    | 600337.61 | 1172027.83 | 218.48 | HOR      | 918    | 600384.29 | 1172096.71 | 220.43 | NZP     |
| 836    | 600338.79 | 1172027.14 | 218.08 |          | 919    | 600389.05 | 1172103.09 | 220.79 | NZP     |
| 837    | 600336.06 | 1172028.76 | 218.65 | BET      | 920    | 600391.99 | 1172106.36 | 221.04 | NZP     |
| 838    | 600333.09 | 1172031.11 | 218.67 |          | 921    | 600394.55 | 1172107.75 | 221.13 | NZP     |
| 839    | 600329.96 | 1172032.69 | 218.63 | AC       | 922    | 600397.42 | 1172107.78 | 221.17 | NZP     |
| 840    | 600328.78 | 1172033.34 | 218.48 | VS       | 923    | 600401.10 | 1172113.74 | 221.28 | XNZP    |
| 841    | 600327.82 | 1172034.14 | 217.96 |          | 924    | 600398.63 | 1172116.25 | 221.35 | NZP     |
| 842    | 600340.91 | 1172055.23 | 218.32 |          | 925    | 600397.83 | 1172119.08 | 221.62 | NZP     |
| 843    | 600342.20 | 1172055.26 | 218.89 | VS       | 926    | 600398.08 | 1172122.97 | 221.96 | NZP     |
| 844    | 600343.99 | 1172054.73 | 219.14 | AC       | 927    | 600386.74 | 1172107.65 | 221.04 | BET     |
| 845    | 600347.02 | 1172052.85 | 219.18 |          | 928    | 600391.08 | 1172114.13 | 221.45 | BET     |
| 846    | 600350.73 | 1172051.49 | 219.16 | BET      | 929    | 600395.21 | 1172120.70 | 221.84 | BET     |
| 847    | 600351.50 | 1172050.76 | 219.06 | HOR      | 930    | 600399.73 | 1172127.93 | 222.30 | NZP BET |
| 848    | 600352.46 | 1172050.03 | 218.68 |          | 931    | 600400.70 | 1172126.48 | 222.24 | ZNACKA  |
| 849    | 600364.09 | 1172067.67 | 219.13 |          | 932    | 600398.96 | 1172122.62 | 221.85 | XVS     |
| 850    | 600362.30 | 1172067.71 | 219.61 | HOR      | 933    | 600400.28 | 1172121.70 | 221.56 |         |
| 851    | 600361.24 | 1172067.92 | 219.61 | BET XNZP | 934    | 600403.83 | 1172129.42 | 221.96 |         |
| 852    | 600358.20 | 1172070.13 | 219.68 |          | 935    | 600402.91 | 1172130.44 | 222.32 | VS      |
| 853    | 600355.20 | 1172072.38 | 219.62 | AC       | 936    | 600401.77 | 1172131.35 | 222.46 | BET     |
| 854    | 600353.45 | 1172073.53 | 219.45 | VS       | 937    | 600405.97 | 1172137.72 | 222.69 | BET     |
| 855    | 600352.51 | 1172074.28 | 219.10 |          | 938    | 600407.24 | 1172137.20 | 222.61 | VS      |
| 856    | 600360.81 | 1172087.97 | 219.61 |          | 939    | 600408.53 | 1172136.29 | 222.11 |         |
| 857    | 600362.57 | 1172087.42 | 219.93 |          | 940    | 600415.42 | 1172147.48 | 222.53 |         |
| 858    | 600364.11 | 1172086.49 | 220.07 | AC       | 941    | 600414.59 | 1172148.49 | 222.97 | VS      |
| 859    | 600367.32 | 1172084.46 | 220.15 |          | 942    | 600413.28 | 1172149.18 | 223.07 | BET     |
| 860    | 600370.41 | 1172082.39 | 220.13 | BET      | 943    | 600420.61 | 1172160.12 | 223.39 | BET     |
| 861    | 600371.69 | 1172081.30 | 219.94 | HOR      | 944    | 600421.93 | 1172159.61 | 223.23 | VS      |
| 862    | 600371.43 | 1172081.93 | 220.01 | NZP      | 945    | 600422.75 | 1172159.02 | 222.91 |         |
| 863    | 600378.95 | 1172090.56 | 220.07 | NZP      | 946    | 600433.33 | 1172175.14 | 223.09 |         |
| 864    | 600377.89 | 1172088.67 | 219.95 | HOR      | 947    | 600432.35 | 1172175.97 | 223.51 | VS      |
| 865    | 600375.80 | 1172090.82 | 220.38 | BET      | 948    | 600431.69 | 1172176.76 | 223.58 | XNZP    |
| 866    | 600372.91 | 1172093.32 | 220.44 |          | 949    | 600431.44 | 1172177.13 | 223.57 | BET     |
| 867    | 600369.69 | 1172095.18 | 220.35 | AC       | 950    | 600428.99 | 1172179.36 | 223.61 |         |
| 868    | 600366.52 | 1172091.01 | 220.19 | XNZP1    | 951    | 600426.47 | 1172182.36 | 223.53 | AC      |
| 869    | 600368.26 | 1172094.21 | 220.25 | NZP1     | 952    | 600425.73 | 1172183.07 | 223.53 |         |
| 870    | 600368.82 | 1172096.98 | 220.29 | NZP1     | 953    | 600424.86 | 1172184.29 | 223.50 |         |
| 871    | 600368.89 | 1172099.71 | 220.30 | NZP1     | 954    | 600430.69 | 1172191.66 | 223.45 | XSS     |
| 872    | 600368.23 | 1172101.79 | 220.24 | NZP1     | 955    | 600436.71 | 1172201.05 | 223.59 | SS      |
| 873    | 600369.93 | 1172096.60 | 220.33 | AC       | 956    | 600437.61 | 1172200.98 | 223.76 |         |
| 874    | 600370.17 | 1172099.07 | 220.32 | AC       | 957    | 600438.29 | 1172200.77 | 223.78 | AC      |
| 875    | 600369.32 | 1172101.57 | 220.26 | AC       | 958    | 600441.46 | 1172198.96 | 223.82 |         |
| 876    | 600367.02 | 1172105.03 | 220.10 | AC NZP1  | 959    | 600444.71 | 1172197.10 | 223.81 | BET     |
| 877    | 600364.96 | 1172101.82 | 220.00 | KRIZEK   | 960    | 600445.22 | 1172196.90 | 223.84 | NZP     |
| 878    | 600365.27 | 1172098.93 | 219.91 |          | 961    | 600445.64 | 1172196.20 | 223.79 | VS      |
| 879    | 600364.76 | 1172095.81 | 219.96 |          | 962    | 600446.27 | 1172195.22 | 223.47 |         |
| 880    | 600374.75 | 1172101.89 | 220.65 |          | 963    | 600446.11 | 1172196.21 | 223.78 | ZNACKA  |
| 881    | 600379.94 | 1172110.47 | 220.99 |          | 964    | 600456.58 | 1172210.54 | 223.44 | ZNACKA  |
| 882    | 600384.62 | 1172117.81 | 221.41 |          | 965    | 600455.66 | 1172211.57 | 223.86 | VS      |
| 883    | 600391.11 | 1172127.78 | 222.00 |          | 966    | 600455.29 | 1172212.06 | 223.95 | NZP     |
| 884    | 600375.99 | 1172116.26 | 220.69 |          | 967    | 600454.82 | 1172212.48 | 223.92 | BET     |
| 885    | 600372.67 | 1172111.68 | 220.49 |          | 968    | 600452.05 | 1172214.61 | 223.95 |         |
| 886    | 600369.64 | 1172107.52 | 220.28 |          | 969    | 600449.10 | 1172216.85 | 223.88 | AC      |
| 887    | 600374.82 | 1172119.15 | 220.50 | XAC      | 970    | 600448.40 | 1172217.25 | 223.89 |         |
| 888    | 600375.03 | 1172119.72 | 220.41 | XSS      | 971    | 600447.56 | 1172217.67 | 223.70 | SS      |
| 889    | 600375.31 | 1172120.96 | 220.70 |          | 972    | 600461.94 | 1172240.23 | 223.83 |         |
| 890    | 600380.84 | 1172124.31 | 221.18 |          | 973    | 600463.21 | 1172239.87 | 224.04 |         |
| 891    | 600381.89 | 1172123.01 | 221.08 | SS       | 974    | 600463.94 | 1172239.72 | 224.08 | AC      |
| 892    | 600382.21 | 1172122.62 | 221.25 | AC       | 975    | 600466.84 | 1172237.45 | 224.18 |         |
| 893    | 600386.55 | 1172126.13 | 221.63 | AC       | 976    | 600470.04 | 1172235.29 | 224.16 | BET     |
| 894    | 600386.42 | 1172126.45 | 221.49 | SS       | 977    | 600470.44 | 1172235.13 | 224.19 | NZP     |
| 895    | 600385.30 | 1172127.91 | 221.54 |          | 978    | 600471.16 | 1172234.78 | 224.13 | VS      |
| 896    | 600390.34 | 1172134.14 | 222.08 |          | 979    | 600472.07 | 1172234.27 | 223.82 |         |
| 897    | 600391.61 | 1172133.61 | 222.02 |          | 980    | 600478.52 | 1172243.87 | 223.88 |         |
| 898    | 600391.99 | 1172133.41 | 221.93 | SS       | 981    | 600477.75 | 1172245.01 | 224.27 | VS      |
| 899    | 600392.39 | 1172133.06 | 222.20 | AC       | 982    | 600477.04 | 1172245.09 | 224.32 | NZP     |
| 900    | 600394.86 | 1172134.84 | 222.40 | AC       | 983    | 600476.71 | 1172245.27 | 224.30 | BET     |
| 901    | 600398.44 | 1172140.24 | 222.59 | AC       | 984    | 600473.80 | 1172247.63 | 224.29 |         |
| 902    | 600397.75 | 1172140.99 | 222.54 |          | 985    | 600470.45 | 1172249.49 | 224.17 | AC      |
| 903    | 600396.44 | 1172142.48 | 222.49 |          | 986    | 600468.98 | 1172249.92 | 224.10 | ZNACKA  |
| 904    | 600403.02 | 1172152.45 | 222.97 |          | 987    | 600468.74 | 1172251.54 | 224.06 |         |
| 905    | 600404.46 | 1172151.98 | 222.88 |          | 988    | 600485.28 | 1172274.75 | 224.30 | XDLN    |
| 906    | 600405.95 | 1172151.40 | 222.99 | AC       | 989    | 600486.43 | 1172274.62 | 224.49 | XHOR    |
| 907    | 600414.08 | 1172163.77 | 223.30 | AC       | 990    | 600487.13 | 1172274.70 | 224.47 | AC      |
| 908    | 600413.14 | 1172164.64 | 223.15 |          | 991    | 600490.12 | 1172272.73 | 224.56 |         |
| 909    | 600412.08 | 1172165.75 | 223.15 |          | 992    | 600493.81 | 1172270.84 | 224.52 | BET     |
| 910    | 600417.57 | 1172162.34 | 223.34 |          | 993    | 600494.68 | 1172270.48 | 224.49 | VS      |
| 911    | 600410.25 | 1172151.01 | 223.09 |          | 994    | 600495.65 | 1172269.75 | 224.10 |         |
| 912    | 600402.17 | 1172138.70 | 222.69 |          | 995    | 600507.71 | 1172287.88 | 224.28 |         |
| 913    | 600396.13 | 1172129.44 | 222.27 |          | 996    | 600506.69 | 1172289.04 | 224.68 | VS      |

| č.bodu | Y         | X          | Z      | popis      | č.bodu | Y         | X          | Z      | popis        |
|--------|-----------|------------|--------|------------|--------|-----------|------------|--------|--------------|
| 997    | 600506.23 | 1172289.57 | 224.71 | BET        | 1080   | 600586.88 | 1172424.54 | 223.58 | CHO1         |
| 998    | 600503.22 | 1172292.27 | 224.73 |            | 1081   | 600587.74 | 1172425.06 | 223.61 | CHO1         |
| 999    | 600500.16 | 1172294.31 | 224.67 | AC         | 1082   | 600588.52 | 1172425.73 | 223.62 | CHO1         |
| 1000   | 600499.41 | 1172294.75 | 224.65 | HOR        | 1083   | 600589.07 | 1172426.44 | 223.50 | CHO1         |
| 1001   | 600498.87 | 1172295.25 | 224.45 | DLN        | 1084   | 600589.20 | 1172426.34 | 223.50 | CHO CES      |
| 1002   | 600510.64 | 1172312.85 | 224.46 | DLN        | 1085   | 600589.40 | 1172426.95 | 223.50 | XHOR         |
| 1003   | 600511.75 | 1172312.76 | 224.72 | HOR        | 1086   | 600589.01 | 1172427.47 | 223.35 | XDNL         |
| 1004   | 600512.41 | 1172312.36 | 224.69 | AC         | 1087   | 600590.68 | 1172413.98 | 223.55 | BET          |
| 1005   | 600515.23 | 1172310.29 | 224.75 |            | 1088   | 600591.15 | 1172413.46 | 223.55 | VS           |
| 1006   | 600517.56 | 1172306.52 | 224.75 | BET        | 1089   | 600591.77 | 1172413.27 | 223.47 | ZNACKA       |
| 1007   | 600518.29 | 1172306.11 | 224.68 | VS         | 1090   | 600591.96 | 1172412.49 | 223.26 |              |
| 1008   | 600519.65 | 1172305.67 | 224.30 |            | 1091   | 600597.72 | 1172420.70 | 223.00 |              |
| 1009   | 600520.51 | 1172305.15 | 224.45 | ZNACKA     | 1092   | 600596.96 | 1172421.91 | 223.45 | VS           |
| 1010   | 600538.20 | 1172334.43 | 224.34 | ZNACKA     | 1093   | 600596.19 | 1172422.35 | 223.46 | BET          |
| 1011   | 600538.18 | 1172333.31 | 224.19 |            | 1094   | 600592.72 | 1172424.48 | 223.52 |              |
| 1012   | 600536.60 | 1172333.52 | 224.53 | VS         | 1095   | 600587.48 | 1172416.41 | 223.62 |              |
| 1013   | 600535.85 | 1172333.69 | 224.57 | BET        | 1096   | 600600.96 | 1172426.11 | 223.13 | ZNACKA       |
| 1014   | 600532.71 | 1172335.99 | 224.63 |            | 1097   | 600606.81 | 1172434.79 | 223.10 | ZNACKA       |
| 1015   | 600529.83 | 1172338.40 | 224.52 | AC         | 1098   | 600606.83 | 1172433.73 | 222.90 |              |
| 1016   | 600529.31 | 1172339.01 | 224.50 | HOR        | 1099   | 600606.83 | 1172433.72 | 222.90 |              |
| 1017   | 600528.70 | 1172339.88 | 224.20 | DLN        | 1100   | 600605.18 | 1172434.03 | 223.33 | VS           |
| 1018   | 600541.25 | 1172358.22 | 224.08 | DLN        | 1101   | 600604.54 | 1172434.31 | 223.35 | BET          |
| 1019   | 600542.33 | 1172358.03 | 224.35 | HOR        | 1102   | 600601.54 | 1172436.88 | 223.43 |              |
| 1020   | 600543.04 | 1172357.84 | 224.34 | AC         | 1103   | 600598.51 | 1172438.79 | 223.36 | AC           |
| 1021   | 600545.91 | 1172355.59 | 224.39 |            | 1104   | 600597.83 | 1172439.21 | 223.40 | HOR          |
| 1022   | 600549.44 | 1172353.76 | 224.37 | BET        | 1105   | 600597.13 | 1172439.68 | 223.13 | DLN          |
| 1023   | 600549.72 | 1172353.48 | 224.37 | XNZP       | 1106   | 600607.22 | 1172454.15 | 223.06 | DLN          |
| 1024   | 600550.27 | 1172353.25 | 224.32 | VS         | 1107   | 600607.85 | 1172453.86 | 223.22 | HOR          |
| 1025   | 600551.23 | 1172352.35 | 223.97 |            | 1108   | 600608.54 | 1172453.58 | 223.18 | AC           |
| 1026   | 600566.75 | 1172375.40 | 223.67 | MIST       | 1109   | 600611.58 | 1172451.79 | 223.19 |              |
| 1027   | 600565.99 | 1172376.52 | 224.03 | VS         | 1110   | 600614.86 | 1172449.60 | 223.16 | BET          |
| 1028   | 600565.76 | 1172376.94 | 224.06 | NZP        | 1111   | 600615.53 | 1172449.09 | 223.12 | VS           |
| 1029   | 600565.37 | 1172377.32 | 224.06 | BET        | 1112   | 600616.31 | 1172448.23 | 222.72 |              |
| 1030   | 600562.67 | 1172379.83 | 224.13 |            | 1113   | 600619.31 | 1172453.54 | 222.99 | SZEL         |
| 1031   | 600559.80 | 1172382.60 | 224.07 | AC         | 1114   | 600618.57 | 1172452.56 | 223.06 | ZNACKA       |
| 1032   | 600559.29 | 1172383.33 | 224.06 | HOR        | 1115   | 600620.03 | 1172457.05 | 223.09 | BET          |
| 1033   | 600558.81 | 1172383.91 | 223.90 | DLN        | 1116   | 600616.85 | 1172459.46 | 223.15 |              |
| 1034   | 600556.60 | 1172381.29 | 223.97 | MIST       | 1117   | 600614.00 | 1172461.79 | 223.11 | AC XNZP      |
| 1035   | 600569.64 | 1172399.93 | 223.53 | DLN        | 1118   | 600614.05 | 1172464.53 | 223.06 | HOR DLN      |
| 1036   | 600570.81 | 1172399.81 | 223.85 | HOR        | 1119   | 600616.46 | 1172470.84 | 222.84 | LLAMPA       |
| 1037   | 600571.45 | 1172399.58 | 223.82 | AC         | 1120   | 600616.91 | 1172469.91 | 222.85 | NZP          |
| 1038   | 600574.49 | 1172397.52 | 223.87 |            | 1121   | 600620.53 | 1172476.69 | 222.79 | NZP          |
| 1039   | 600577.55 | 1172394.83 | 223.83 | BET NZP    | 1122   | 600619.62 | 1172477.02 | 222.55 | SKRUH        |
| 1040   | 600578.20 | 1172394.52 | 223.81 | VS         | 1123   | 600622.54 | 1172475.04 | 222.92 | AC           |
| 1041   | 600579.18 | 1172393.85 | 223.36 |            | 1124   | 600625.85 | 1172472.84 | 223.02 |              |
| 1042   | 600588.06 | 1172406.29 | 223.18 |            | 1125   | 600622.40 | 1172481.34 | 222.55 | AUTOBUS      |
| 1043   | 600587.02 | 1172407.28 | 223.65 | VS         | 1126   | 600627.18 | 1172487.89 | 222.76 | NZP          |
| 1044   | 600586.48 | 1172407.77 | 223.67 | AC         | 1127   | 600630.29 | 1172486.05 | 222.78 | AC           |
| 1045   | 600583.25 | 1172410.34 | 223.72 |            | 1128   | 600633.49 | 1172484.07 | 222.87 |              |
| 1046   | 600579.54 | 1172411.18 | 223.65 | AC         | 1129   | 600632.53 | 1172495.15 | 222.75 | LLAMPA       |
| 1047   | 600580.22 | 1172412.49 | 223.63 | AC         | 1130   | 600635.21 | 1172498.21 | 222.65 | NZP          |
| 1048   | 600579.32 | 1172411.71 | 223.64 | XCES       | 1131   | 600633.05 | 1172500.10 | 222.48 | XIVAN XIVAN1 |
| 1049   | 600579.20 | 1172411.72 | 223.66 | XCES1      | 1132   | 600634.63 | 1172498.98 | 222.63 | IVAN         |
| 1050   | 600578.98 | 1172411.72 | 223.72 | XAC1       | 1133   | 600636.32 | 1172501.55 | 222.58 | IVAN         |
| 1051   | 600579.93 | 1172412.79 | 223.65 | CES1 XCHO2 | 1134   | 600634.77 | 1172502.63 | 222.46 | IVAN IVAN1   |
| 1052   | 600579.12 | 1172411.71 | 223.66 | XCHO       | 1135   | 600637.58 | 1172501.75 | 222.61 | NZP          |
| 1053   | 600579.80 | 1172413.42 | 223.76 | AC1        | 1136   | 600640.03 | 1172500.21 | 222.59 | AC           |
| 1054   | 600579.92 | 1172413.34 | 223.62 | CHO        | 1137   | 600643.04 | 1172498.05 | 222.69 |              |
| 1055   | 600580.17 | 1172413.35 | 223.63 | CHO2       | 1138   | 600643.16 | 1172505.28 | 222.58 | XCES         |
| 1056   | 600580.35 | 1172414.39 | 223.58 | CHO2       | 1139   | 600644.60 | 1172506.61 | 222.56 | CES AC       |
| 1057   | 600580.10 | 1172414.37 | 223.57 | CHO        | 1140   | 600642.99 | 1172505.27 | 222.63 | XAC1         |
| 1058   | 600579.97 | 1172414.36 | 223.71 | AC1        | 1141   | 600644.21 | 1172506.46 | 222.67 | AC1          |
| 1059   | 600579.84 | 1172416.38 | 223.55 | AC1        | 1142   | 600644.95 | 1172507.13 | 222.58 | XCES AC1     |
| 1060   | 600580.00 | 1172416.39 | 223.41 | CHO        | 1143   | 600647.16 | 1172510.41 | 222.53 | AC1          |
| 1061   | 600580.24 | 1172416.44 | 223.42 | CHO2       | 1144   | 600647.27 | 1172510.36 | 222.51 | AC           |
| 1062   | 600580.81 | 1172413.83 | 223.60 | AC CES     | 1145   | 600647.80 | 1172511.65 | 222.51 | AC           |
| 1063   | 600587.12 | 1172422.99 | 223.49 | AC XCES    | 1146   | 600647.64 | 1172511.69 | 222.61 | AC1          |
| 1064   | 600589.23 | 1172426.16 | 223.48 | CES        | 1147   | 600648.11 | 1172513.65 | 222.59 | AC1          |
| 1065   | 600589.55 | 1172425.88 | 223.47 | AC         | 1148   | 600648.25 | 1172513.65 | 222.48 | AC           |
| 1066   | 600581.92 | 1172415.68 | 223.61 | CES1       | 1149   | 600648.26 | 1172515.65 | 222.42 | AC           |
| 1067   | 600587.21 | 1172423.38 | 223.50 | CES1       | 1150   | 600648.13 | 1172515.64 | 222.52 | AC1          |
| 1068   | 600584.96 | 1172423.62 | 223.35 | XCHO2      | 1151   | 600647.67 | 1172517.56 | 222.45 | AC1          |
| 1069   | 600584.94 | 1172423.87 | 223.32 | XCHO       | 1152   | 600647.79 | 1172517.63 | 222.35 | AC           |
| 1070   | 600584.89 | 1172424.02 | 223.47 | XCHO1      | 1153   | 600646.88 | 1172519.42 | 222.23 | AC           |
| 1071   | 600585.94 | 1172424.19 | 223.53 | CHO1       | 1154   | 600646.77 | 1172519.34 | 222.36 | AC1          |
| 1072   | 600585.99 | 1172424.08 | 223.38 | CHO        | 1155   | 600645.38 | 1172517.97 | 222.42 | XCHO         |
| 1073   | 600586.14 | 1172423.86 | 223.40 | CHO2       | 1156   | 600646.16 | 1172516.07 | 222.52 | CHO          |
| 1074   | 600587.15 | 1172424.25 | 223.44 | CHO2       | 1157   | 600646.24 | 1172514.04 | 222.61 | CHO          |
| 1075   | 600588.01 | 1172424.74 | 223.47 | CHO2       | 1158   | 600645.80 | 1172512.09 | 222.67 | CHO          |
| 1076   | 600586.94 | 1172424.45 | 223.43 | CHO        | 1159   | 600645.37 | 1172511.17 | 222.68 | CHO          |
| 1077   | 600587.81 | 1172424.94 | 223.47 | CHO        | 1160   | 600643.43 | 1172508.22 | 222.74 | CHO CES NZP  |
| 1078   | 600588.61 | 1172425.64 | 223.49 | CHO        | 1161   | 600645.00 | 1172512.91 | 222.69 | LLAMPA       |
| 1079   | 600588.36 | 1172425.08 | 223.50 | CHO2 CES1  | 1162   | 600653.17 | 1172520.08 | 222.44 |              |

| č.bodu | Y         | X          | Z      | popis     | č.bodu | Y         | X          | Z      | popis     |
|--------|-----------|------------|--------|-----------|--------|-----------|------------|--------|-----------|
| 1163   | 600656.37 | 1172524.79 | 222.39 |           | 1246   | 600659.04 | 1172509.93 | 222.68 | ZNACKA    |
| 1164   | 600650.43 | 1172527.01 | 222.18 |           | 1247   | 600652.29 | 1172499.83 | 222.77 | LLAMPA    |
| 1165   | 600654.34 | 1172535.96 | 222.21 | XAC1      | 1248   | 600660.48 | 1172516.30 | 222.50 | BET       |
| 1166   | 600654.50 | 1172535.98 | 222.14 | XNZP      | 1249   | 600660.62 | 1172516.27 | 222.62 | AC1       |
| 1167   | 600654.94 | 1172535.42 | 222.07 | XAC       | 1250   | 600664.78 | 1172522.37 | 222.61 | AC1       |
| 1168   | 600660.43 | 1172538.20 | 222.19 | AC        | 1251   | 600664.68 | 1172522.45 | 222.50 | BET       |
| 1169   | 600660.07 | 1172538.60 | 222.18 | NZP       | 1252   | 600667.59 | 1172522.72 | 222.70 | ZNACKA    |
| 1170   | 600660.17 | 1172539.01 | 222.21 | SBET      | 1253   | 600667.72 | 1172526.25 | 222.58 | AC1       |
| 1171   | 600663.52 | 1172539.73 | 222.27 | AC XNZP   | 1254   | 600667.78 | 1172526.53 | 222.46 | BET       |
| 1172   | 600663.09 | 1172541.34 | 222.26 |           | 1255   | 600669.39 | 1172528.40 | 222.43 | BET       |
| 1173   | 600665.36 | 1172544.43 | 222.25 |           | 1256   | 600669.51 | 1172528.32 | 222.57 | AC1       |
| 1174   | 600666.89 | 1172543.28 | 222.31 | NZP       | 1257   | 600671.71 | 1172530.32 | 222.52 | AC1       |
| 1175   | 600667.72 | 1172542.83 | 222.33 | AC        | 1258   | 600671.66 | 1172530.45 | 222.41 | BET       |
| 1176   | 600669.70 | 1172544.62 | 222.37 | AC        | 1259   | 600674.01 | 1172532.22 | 222.38 | BET       |
| 1177   | 600672.93 | 1172549.38 | 222.31 | AC        | 1260   | 600674.14 | 1172532.14 | 222.49 | AC1       |
| 1178   | 600672.52 | 1172550.01 | 222.33 | NZP       | 1261   | 600675.87 | 1172530.36 | 222.49 | SBET      |
| 1179   | 600671.38 | 1172551.21 | 222.37 |           | 1262   | 600677.52 | 1172534.22 | 222.47 | AC1       |
| 1180   | 600675.20 | 1172557.28 | 222.21 |           | 1263   | 600677.45 | 1172534.34 | 222.36 | BET       |
| 1181   | 600676.67 | 1172556.54 | 222.34 | ZNACKA    | 1264   | 600680.20 | 1172535.63 | 222.37 | BET       |
| 1182   | 600677.34 | 1172556.13 | 222.33 | NZP       | 1265   | 600680.22 | 1172535.50 | 222.49 | AC1       |
| 1183   | 600677.83 | 1172556.05 | 222.32 | AC        | 1266   | 600684.06 | 1172536.69 | 222.49 | AC1       |
| 1184   | 600684.32 | 1172565.42 | 222.30 | AC        | 1267   | 600684.02 | 1172536.81 | 222.37 | BET       |
| 1185   | 600684.09 | 1172565.82 | 222.31 | NZP       | 1268   | 600684.20 | 1172540.29 | 222.42 |           |
| 1186   | 600682.93 | 1172566.99 | 222.13 |           | 1269   | 600678.80 | 1172544.11 | 222.41 |           |
| 1187   | 600685.23 | 1172570.54 | 222.34 | ZNACKA    | 1270   | 600672.63 | 1172535.20 | 222.44 |           |
| 1188   | 600689.23 | 1172578.24 | 222.24 | XVS       | 1271   | 600684.09 | 1172547.18 | 222.58 | ZNACKA    |
| 1189   | 600690.98 | 1172577.82 | 222.27 | VS        | 1272   | 600686.01 | 1172544.62 | 222.41 | XBET      |
| 1190   | 600692.59 | 1172579.48 | 222.26 | VS        | 1273   | 600686.00 | 1172544.77 | 222.58 | XBET1     |
| 1191   | 600691.63 | 1172581.93 | 221.91 |           | 1274   | 600684.43 | 1172545.42 | 222.56 | BET1      |
| 1192   | 600696.92 | 1172577.47 | 222.39 |           | 1275   | 600684.36 | 1172545.32 | 222.42 | BET       |
| 1193   | 600690.29 | 1172567.77 | 222.37 |           | 1276   | 600683.06 | 1172547.01 | 222.40 | BET       |
| 1194   | 600687.83 | 1172564.29 | 222.40 |           | 1277   | 600683.13 | 1172547.16 | 222.55 | BET1      |
| 1195   | 600681.24 | 1172554.91 | 222.39 |           | 1278   | 600682.95 | 1172548.91 | 222.57 | BET1      |
| 1196   | 600677.02 | 1172548.26 | 222.45 |           | 1279   | 600682.80 | 1172548.98 | 222.42 | BET       |
| 1197   | 600669.97 | 1172537.93 | 222.48 |           | 1280   | 600684.07 | 1172551.28 | 222.41 | BET       |
| 1198   | 600662.21 | 1172526.53 | 222.48 |           | 1281   | 600684.16 | 1172551.16 | 222.56 | BET1      |
| 1199   | 600652.52 | 1172512.11 | 222.56 |           | 1282   | 600685.60 | 1172553.20 | 222.53 | BET1      |
| 1200   | 600642.43 | 1172497.16 | 222.71 |           | 1283   | 600685.54 | 1172553.35 | 222.36 | BET       |
| 1201   | 600633.63 | 1172484.28 | 222.86 |           | 1284   | 600687.53 | 1172553.97 | 222.33 | BET       |
| 1202   | 600624.62 | 1172470.91 | 223.05 |           | 1285   | 600687.57 | 1172553.82 | 222.48 | BET1      |
| 1203   | 600616.50 | 1172458.90 | 223.15 |           | 1286   | 600690.10 | 1172553.93 | 222.44 | BET1      |
| 1204   | 600620.05 | 1172457.14 | 223.09 | BET XBET2 | 1287   | 600690.07 | 1172554.08 | 222.29 | BET       |
| 1205   | 600620.30 | 1172457.05 | 223.09 | BET2 XCES | 1288   | 600692.29 | 1172553.53 | 222.29 | BET       |
| 1206   | 600622.70 | 1172459.08 | 223.08 | CES       | 1289   | 600692.24 | 1172553.40 | 222.46 | BET1      |
| 1207   | 600625.13 | 1172460.41 | 222.99 | CES       | 1290   | 600692.57 | 1172551.81 | 222.40 | ZNACKA    |
| 1208   | 600627.04 | 1172461.36 | 222.97 | CES       | 1291   | 600694.50 | 1172555.86 | 222.24 |           |
| 1209   | 600628.70 | 1172461.67 | 222.97 | CES       | 1292   | 600688.66 | 1172559.02 | 222.38 |           |
| 1210   | 600629.66 | 1172470.70 | 222.94 | BET2      | 1293   | 600692.89 | 1172565.11 | 222.37 |           |
| 1211   | 600629.42 | 1172470.86 | 222.95 | BET       | 1294   | 600698.04 | 1172560.74 | 222.21 | ZNACKA    |
| 1212   | 600637.91 | 1172468.96 | 222.78 | SKRUH     | 1295   | 600697.94 | 1172558.94 | 222.24 | XBET1     |
| 1213   | 600638.87 | 1172469.19 | 222.74 | HYDRANT   | 1296   | 600697.84 | 1172558.83 | 222.15 | XBET      |
| 1214   | 600636.46 | 1172469.02 | 222.78 | XCES      | 1297   | 600696.82 | 1172561.70 | 222.12 | BET       |
| 1215   | 600635.49 | 1172471.36 | 222.81 | CES       | 1298   | 600696.93 | 1172561.76 | 222.21 | BET1      |
| 1216   | 600634.93 | 1172473.65 | 222.81 | CES       | 1299   | 600696.62 | 1172563.71 | 222.24 | BET1      |
| 1217   | 600634.87 | 1172475.69 | 222.81 | CES       | 1300   | 600696.49 | 1172563.70 | 222.15 | BET       |
| 1218   | 600635.16 | 1172477.53 | 222.77 | CES       | 1301   | 600696.47 | 1172565.74 | 222.19 | BET       |
| 1219   | 600635.69 | 1172479.00 | 222.76 | CES       | 1302   | 600696.60 | 1172565.72 | 222.30 | BET1      |
| 1220   | 600636.30 | 1172480.36 | 222.76 | CES BET2  | 1303   | 600696.78 | 1172567.72 | 222.36 | BET1      |
| 1221   | 600636.69 | 1172481.03 | 222.75 | BET2      | 1304   | 600696.66 | 1172567.76 | 222.28 | BET       |
| 1222   | 600637.23 | 1172481.79 | 222.76 | BET2      | 1305   | 600697.17 | 1172569.72 | 222.33 | BET       |
| 1223   | 600637.05 | 1172481.92 | 222.79 | BET2 BET  | 1306   | 600697.30 | 1172569.70 | 222.44 | BET1      |
| 1224   | 600637.10 | 1172470.99 | 222.75 | XNZP      | 1307   | 600699.04 | 1172568.16 | 222.32 | SKRUH     |
| 1225   | 600639.13 | 1172475.79 | 222.75 | NZP       | 1308   | 600697.91 | 1172571.62 | 222.32 | BET       |
| 1226   | 600642.88 | 1172481.26 | 222.64 | NZP       | 1309   | 600698.01 | 1172571.53 | 222.43 | BET1      |
| 1227   | 600646.28 | 1172486.73 | 222.70 | NZP       | 1310   | 600698.48 | 1172572.42 | 222.43 | BET1      |
| 1228   | 600647.54 | 1172492.15 | 222.70 | XAC1      | 1311   | 600698.38 | 1172572.49 | 222.32 | BET       |
| 1229   | 600644.47 | 1172492.67 | 222.66 | BET       | 1312   | 600698.89 | 1172573.75 | 222.31 | VPUST     |
| 1230   | 600648.64 | 1172498.77 | 222.57 | BET       | 1313   | 600701.00 | 1172576.39 | 222.32 | BET       |
| 1231   | 600648.15 | 1172494.94 | 222.73 | AC1       | 1314   | 600701.29 | 1172576.59 | 222.43 | BET1      |
| 1232   | 600649.21 | 1172498.36 | 222.75 | AC1       | 1315   | 600710.84 | 1172588.29 | 222.29 | SKRUH     |
| 1233   | 600650.59 | 1172502.13 | 222.70 | AC1       | 1316   | 600710.92 | 1172590.60 | 222.46 | BET1      |
| 1234   | 600650.96 | 1172503.05 | 222.58 | AC1 XCES  | 1317   | 600710.81 | 1172590.66 | 222.34 | BET       |
| 1235   | 600650.82 | 1172503.14 | 222.56 | BET       | 1318   | 600711.50 | 1172591.44 | 222.38 | BET1 XCES |
| 1236   | 600652.63 | 1172501.92 | 222.71 | CES       | 1319   | 600713.29 | 1172590.23 | 222.23 | CES       |
| 1237   | 600653.06 | 1172502.57 | 222.70 | CES       | 1320   | 600713.66 | 1172591.20 | 222.24 | XCES      |
| 1238   | 600653.57 | 1172503.02 | 222.74 | CES       | 1321   | 600712.06 | 1172592.23 | 222.37 | CES BET1  |
| 1239   | 600654.22 | 1172503.29 | 222.75 | CES       | 1322   | 600712.63 | 1172593.11 | 222.48 | BET1      |
| 1240   | 600654.93 | 1172503.26 | 222.76 | CES       | 1323   | 600712.50 | 1172593.11 | 222.34 | BET       |
| 1241   | 600655.78 | 1172504.63 | 222.75 | XCES      | 1324   | 600709.51 | 1172595.71 | 222.34 |           |
| 1242   | 600653.27 | 1172506.33 | 222.60 | CES AC1   | 1325   | 600706.83 | 1172598.18 | 222.28 | AC        |
| 1243   | 600653.13 | 1172506.44 | 222.57 | BET       | 1326   | 600706.23 | 1172598.81 | 222.22 | VS        |
| 1244   | 600655.61 | 1172509.16 | 222.56 | BET       | 1327   | 600704.81 | 1172599.98 | 221.79 |           |
| 1245   | 600655.68 | 1172509.06 | 222.64 | AC1       | 1328   | 600709.49 | 1172607.47 | 221.91 |           |

| č.bodu | Y         | X          | Z      | popis     | č.bodu | Y         | X          | Z      | popis         |
|--------|-----------|------------|--------|-----------|--------|-----------|------------|--------|---------------|
| 1329   | 600711.34 | 1172606.70 | 222.22 | VS        | 1412   | 600808.34 | 1172723.71 | 220.71 |               |
| 1330   | 600712.33 | 1172606.29 | 222.27 | AC        | 1413   | 600813.36 | 1172729.83 | 220.91 |               |
| 1331   | 600714.90 | 1172603.88 | 222.37 |           | 1414   | 600813.82 | 1172732.05 | 221.22 | ZNACKA        |
| 1332   | 600718.38 | 1172601.75 | 222.33 | BET       | 1415   | 600812.19 | 1172734.26 | 221.65 | BET           |
| 1333   | 600717.15 | 1172599.71 | 222.46 | BET1      | 1416   | 600814.55 | 1172734.73 | 221.58 | BET XNZP      |
| 1334   | 600717.56 | 1172600.28 | 222.39 | BET1 XCES | 1417   | 600819.36 | 1172732.77 | 221.41 | NZP           |
| 1335   | 600719.09 | 1172599.22 | 222.20 | CES       | 1418   | 600817.93 | 1172740.35 | 221.79 | BET           |
| 1336   | 600720.03 | 1172600.22 | 222.16 | XCES      | 1419   | 600824.07 | 1172742.29 | 221.72 | XNZP          |
| 1337   | 600718.35 | 1172601.40 | 222.38 | BET1 CES  | 1420   | 600822.61 | 1172744.08 | 221.83 | NZP           |
| 1338   | 600718.83 | 1172602.13 | 222.47 | BET1      | 1421   | 600822.02 | 1172746.17 | 221.94 | NZP           |
| 1339   | 600721.09 | 1172605.45 | 222.44 | BET1      | 1422   | 600821.32 | 1172746.31 | 221.97 | BET           |
| 1340   | 600721.67 | 1172606.27 | 222.35 | BET1      | 1423   | 600822.38 | 1172748.65 | 222.17 | NZP BET       |
| 1341   | 600721.56 | 1172606.35 | 222.35 | BET       | 1424   | 600819.75 | 1172751.74 | 222.31 |               |
| 1342   | 600723.98 | 1172604.53 | 222.11 | PRISKA    | 1425   | 600809.38 | 1172737.37 | 221.70 |               |
| 1343   | 600724.56 | 1172610.44 | 222.32 | BET1      | 1426   | 600804.68 | 1172740.14 | 221.60 |               |
| 1344   | 600724.47 | 1172610.54 | 222.32 | BET       | 1427   | 600806.10 | 1172739.30 | 221.59 | AC            |
| 1345   | 600725.10 | 1172611.26 | 222.40 | BET1      | 1428   | 600807.28 | 1172741.17 | 221.69 | AC XNZP       |
| 1346   | 600724.11 | 1172611.14 | 222.32 |           | 1429   | 600805.01 | 1172744.36 | 221.62 | NZP           |
| 1347   | 600721.65 | 1172613.79 | 222.33 |           | 1430   | 600808.45 | 1172748.97 | 221.61 | XNZP          |
| 1348   | 600718.97 | 1172615.96 | 222.24 | AC        | 1431   | 600812.74 | 1172749.04 | 221.99 | NZP AC        |
| 1349   | 600718.33 | 1172616.45 | 222.22 | VS        | 1432   | 600812.40 | 1172749.90 | 221.96 | XVS           |
| 1350   | 600715.96 | 1172617.05 | 221.79 | PRISKA    | 1433   | 600811.74 | 1172750.87 | 221.74 |               |
| 1351   | 600721.21 | 1172622.10 | 222.13 | ZNACKA    | 1434   | 600822.93 | 1172748.40 | 222.11 | XHOR          |
| 1352   | 600730.87 | 1172617.87 | 222.28 | SKRUH     | 1435   | 600824.02 | 1172747.72 | 221.69 |               |
| 1353   | 600743.03 | 1172638.10 | 222.14 | VPUST     | 1436   | 600828.10 | 1172751.74 | 221.70 | PRISKA        |
| 1354   | 600743.68 | 1172638.33 | 222.22 | BET1      | 1437   | 600842.19 | 1172771.37 | 222.17 |               |
| 1355   | 600743.73 | 1172638.63 | 222.12 | BET       | 1438   | 600841.50 | 1172773.64 | 222.77 | HOR           |
| 1356   | 600740.15 | 1172640.45 | 222.15 |           | 1439   | 600841.14 | 1172774.53 | 222.81 | BET           |
| 1357   | 600737.68 | 1172643.25 | 222.06 | AC        | 1440   | 600838.26 | 1172776.86 | 222.85 |               |
| 1358   | 600737.10 | 1172643.75 | 222.06 | VS        | 1441   | 600835.80 | 1172779.31 | 222.78 | AC            |
| 1359   | 600736.16 | 1172644.63 | 221.77 |           | 1442   | 600835.26 | 1172779.93 | 222.75 | VS            |
| 1360   | 600743.00 | 1172654.23 | 221.76 |           | 1443   | 600833.99 | 1172781.35 | 222.40 |               |
| 1361   | 600743.97 | 1172653.89 | 221.96 | VS        | 1444   | 600847.56 | 1172800.29 | 222.81 | KRIZEK        |
| 1362   | 600744.75 | 1172653.49 | 221.98 | AC        | 1445   | 600849.57 | 1172799.13 | 222.94 | VS            |
| 1363   | 600747.50 | 1172651.07 | 222.02 |           | 1446   | 600850.58 | 1172798.95 | 223.00 | AC            |
| 1364   | 600750.00 | 1172647.64 | 222.00 | BET       | 1447   | 600853.24 | 1172796.71 | 223.04 |               |
| 1365   | 600751.75 | 1172646.33 | 221.90 | SKRUH     | 1448   | 600856.27 | 1172794.41 | 223.00 | BET           |
| 1366   | 600750.11 | 1172647.57 | 222.11 | BET1      | 1449   | 600856.86 | 1172793.93 | 222.97 | HOR           |
| 1367   | 600750.68 | 1172648.40 | 222.02 | BET1      | 1450   | 600858.16 | 1172793.10 | 222.47 |               |
| 1368   | 600754.17 | 1172653.34 | 221.94 | BET1      | 1451   | 600868.50 | 1172807.08 | 222.78 |               |
| 1369   | 600754.74 | 1172654.16 | 222.00 | BET1      | 1452   | 600868.07 | 1172808.91 | 223.21 | HOR           |
| 1370   | 600754.59 | 1172654.14 | 221.89 | BET       | 1453   | 600867.71 | 1172809.61 | 223.23 | BET           |
| 1371   | 600758.23 | 1172656.68 | 221.62 |           | 1454   | 600864.88 | 1172812.08 | 223.27 |               |
| 1372   | 600761.61 | 1172663.92 | 221.73 | BET1      | 1455   | 600862.54 | 1172814.78 | 223.18 | AC            |
| 1373   | 600761.49 | 1172663.98 | 221.63 | BET       | 1456   | 600862.00 | 1172815.31 | 223.17 | VS            |
| 1374   | 600758.36 | 1172666.57 | 221.68 |           | 1457   | 600860.75 | 1172816.78 | 222.80 |               |
| 1375   | 600755.37 | 1172668.78 | 221.61 | AC        | 1458   | 600870.20 | 1172828.54 | 223.12 |               |
| 1376   | 600753.01 | 1172669.82 | 221.56 |           | 1459   | 600871.54 | 1172828.08 | 223.39 | VS            |
| 1377   | 600754.24 | 1172671.03 | 221.34 |           | 1460   | 600872.01 | 1172827.30 | 223.39 | AC            |
| 1378   | 600755.27 | 1172670.30 | 221.53 | XVS       | 1461   | 600882.09 | 1172840.60 | 223.65 | AC            |
| 1379   | 600749.03 | 1172662.77 | 221.70 | MIST      | 1462   | 600881.71 | 1172841.16 | 223.63 | VS            |
| 1380   | 600758.28 | 1172656.69 | 221.62 | MIST      | 1463   | 600880.37 | 1172842.71 | 223.26 |               |
| 1381   | 600770.06 | 1172676.14 | 221.03 | BET       | 1464   | 600888.15 | 1172852.19 | 223.49 | ZNACKA        |
| 1382   | 600770.19 | 1172676.11 | 221.15 | BET1      | 1465   | 600890.49 | 1172855.39 | 223.60 |               |
| 1383   | 600772.89 | 1172674.61 | 220.98 | SKRUH     | 1466   | 600892.19 | 1172855.07 | 223.95 | VS            |
| 1384   | 600767.39 | 1172679.40 | 221.07 |           | 1467   | 600892.67 | 1172854.71 | 223.96 | AC            |
| 1385   | 600764.74 | 1172681.79 | 221.04 | AC        | 1468   | 600894.97 | 1172851.95 | 224.05 |               |
| 1386   | 600764.22 | 1172682.38 | 220.99 | VS        | 1469   | 600884.86 | 1172838.46 | 223.73 |               |
| 1387   | 600763.03 | 1172683.40 | 220.56 |           | 1470   | 600874.56 | 1172824.94 | 223.44 |               |
| 1388   | 600767.81 | 1172688.55 | 220.63 | ZNACKA    | 1471   | 600878.65 | 1172822.36 | 223.43 | HOR           |
| 1389   | 600781.09 | 1172687.14 | 220.43 | ZNACKA    | 1472   | 600879.15 | 1172821.12 | 223.00 |               |
| 1390   | 600777.64 | 1172687.34 | 220.66 | VPUST     | 1473   | 600877.25 | 1172821.91 | 223.41 | BET           |
| 1391   | 600777.83 | 1172686.94 | 220.76 | BET1      | 1474   | 600878.25 | 1172822.59 | 223.43 | BET           |
| 1392   | 600778.19 | 1172687.49 | 220.73 | BET1      | 1475   | 600878.33 | 1172822.49 | 223.45 | XBET1         |
| 1393   | 600778.06 | 1172687.54 | 220.68 | BET       | 1476   | 600879.01 | 1172823.15 | 223.58 | BET1          |
| 1394   | 600779.49 | 1172688.31 | 220.60 | XSVOD     | 1477   | 600878.92 | 1172823.24 | 223.45 | XCES XCES1    |
| 1395   | 600785.68 | 1172696.84 | 220.51 | SVOD      | 1478   | 600879.70 | 1172823.85 | 223.47 | CES           |
| 1396   | 600784.91 | 1172697.51 | 220.59 | BET       | 1479   | 600879.79 | 1172823.75 | 223.59 | BET1          |
| 1397   | 600792.59 | 1172708.29 | 220.59 | BET       | 1480   | 600880.95 | 1172824.66 | 223.48 | CES           |
| 1398   | 600793.65 | 1172707.90 | 220.47 | SVOD      | 1481   | 600881.03 | 1172824.54 | 223.59 | BET1          |
| 1399   | 600787.98 | 1172714.99 | 220.48 | XSVOD     | 1482   | 600882.37 | 1172825.13 | 223.59 | BET1          |
| 1400   | 600780.64 | 1172704.92 | 220.48 | SVOD      | 1483   | 600882.32 | 1172825.25 | 223.47 | CES           |
| 1401   | 600772.06 | 1172692.70 | 220.60 | SVOD VS   | 1484   | 600883.34 | 1172825.57 | 223.45 | CES           |
| 1402   | 600772.92 | 1172692.63 | 220.65 | AC        | 1485   | 600883.33 | 1172825.43 | 223.58 | BET1          |
| 1403   | 600780.92 | 1172703.85 | 220.56 | AC        | 1486   | 600884.77 | 1172825.78 | 223.55 | BET1          |
| 1404   | 600789.07 | 1172715.37 | 220.58 | AC        | 1487   | 600884.75 | 1172825.91 | 223.45 | CES           |
| 1405   | 600798.06 | 1172730.87 | 220.84 |           | 1488   | 600886.22 | 1172826.08 | 223.41 | CES           |
| 1406   | 600799.26 | 1172730.57 | 221.09 |           | 1489   | 600886.22 | 1172825.95 | 223.53 | BET1          |
| 1407   | 600799.82 | 1172730.30 | 221.09 | AC        | 1490   | 600885.59 | 1172825.24 | 223.49 | ZNACKA        |
| 1408   | 600802.41 | 1172728.06 | 221.17 |           | 1491   | 600884.20 | 1172822.99 | 223.18 | XDUM          |
| 1409   | 600805.63 | 1172725.69 | 221.13 | BET       | 1492   | 600883.88 | 1172822.55 | 223.14 | DUM           |
| 1410   | 600806.39 | 1172725.08 | 221.05 |           | 1493   | 600881.65 | 1172824.10 | 223.14 | DUM           |
| 1411   | 600808.35 | 1172723.73 | 220.71 |           | 1494   | 600883.11 | 1172823.18 | 222.15 | XKKAN NIVZN60 |

| č.bodu | Y         | X          | Z      | popis    | č.bodu | Y         | X          | Z      | popis   |
|--------|-----------|------------|--------|----------|--------|-----------|------------|--------|---------|
| 1495   | 600890.76 | 1172832.99 | 223.63 | SKRUH    | 1578   | 601014.86 | 1172999.91 | 225.59 |         |
| 1496   | 600888.03 | 1172835.27 | 223.68 | CES1     | 1579   | 601029.99 | 1173018.98 | 225.60 |         |
| 1497   | 600887.96 | 1172835.37 | 223.67 | BET      | 1580   | 601028.08 | 1173019.38 | 226.09 | HOR     |
| 1498   | 600897.47 | 1172840.62 | 223.88 | ZNACKA   | 1581   | 601027.33 | 1173019.70 | 226.13 | BET     |
| 1499   | 600897.90 | 1172843.63 | 223.72 | XDUM     | 1582   | 601024.84 | 1173022.67 | 226.23 |         |
| 1500   | 600899.18 | 1172842.64 | 223.72 | DUM      | 1583   | 601021.89 | 1173024.39 | 226.13 | AC      |
| 1501   | 600899.50 | 1172843.07 | 223.69 | DUM      | 1584   | 601021.26 | 1173024.90 | 226.10 | VS      |
| 1502   | 600897.42 | 1172844.69 | 223.69 | DUM      | 1585   | 601020.33 | 1173025.76 | 225.74 |         |
| 1503   | 600898.62 | 1172843.62 | 222.70 | KKAN     | 1586   | 601035.37 | 1173047.64 | 225.79 |         |
| 1504   | 600896.83 | 1172840.36 | 223.92 | XBET1    | 1587   | 601037.91 | 1173046.62 | 226.19 | VS      |
| 1505   | 600896.70 | 1172840.33 | 223.80 | XCES     | 1588   | 601038.64 | 1173046.08 | 226.23 | AC      |
| 1506   | 600896.44 | 1172842.26 | 223.85 | CES      | 1589   | 601041.62 | 1173044.05 | 226.27 |         |
| 1507   | 600896.58 | 1172842.32 | 223.97 | BET1     | 1590   | 601044.80 | 1173041.79 | 226.19 | BET     |
| 1508   | 600896.55 | 1172843.73 | 224.00 | BET1     | 1591   | 601045.40 | 1173041.54 | 226.18 | HOR     |
| 1509   | 600896.41 | 1172843.70 | 223.88 | CES      | 1592   | 601046.76 | 1173040.84 | 225.73 |         |
| 1510   | 600896.65 | 1172845.26 | 223.91 | CES      | 1593   | 601061.57 | 1173059.40 | 225.67 |         |
| 1511   | 600896.79 | 1172845.26 | 224.02 | BET1     | 1594   | 601060.69 | 1173060.88 | 226.15 | HOR     |
| 1512   | 600897.29 | 1172847.09 | 224.05 | BET1     | 1595   | 601060.42 | 1173061.71 | 226.20 | BET     |
| 1513   | 600897.47 | 1172847.54 | 224.06 | BET1     | 1596   | 601057.72 | 1173064.45 | 226.25 |         |
| 1514   | 600897.81 | 1172848.11 | 224.00 | BET1     | 1597   | 601055.22 | 1173067.11 | 226.16 | AC      |
| 1515   | 600897.18 | 1172847.14 | 223.95 | CES      | 1598   | 601054.92 | 1173067.82 | 226.16 | VS      |
| 1516   | 600897.29 | 1172847.42 | 223.96 | CES CES1 | 1599   | 601053.20 | 1173069.62 | 225.81 |         |
| 1517   | 600897.29 | 1172847.60 | 223.95 | BET      | 1600   | 601060.81 | 1173078.46 | 225.77 |         |
| 1518   | 600897.34 | 1172847.57 | 223.95 | BET      | 1601   | 601061.19 | 1173080.81 | 225.52 |         |
| 1519   | 600897.53 | 1172847.97 | 223.96 | BET      | 1602   | 601061.77 | 1173077.60 | 226.01 | VS      |
| 1520   | 600897.87 | 1172848.84 | 223.99 | BET      | 1603   | 601062.88 | 1173079.44 | 225.95 | VS      |
| 1521   | 600897.95 | 1172847.47 | 223.98 | XHOR     | 1604   | 601063.23 | 1173081.16 | 225.87 | VS      |
| 1522   | 600905.88 | 1172858.30 | 224.13 | HOR      | 1605   | 601062.94 | 1173082.96 | 225.80 | VS      |
| 1523   | 600906.89 | 1172857.60 | 223.68 |          | 1606   | 601063.15 | 1173077.75 | 226.09 | AC      |
| 1524   | 600904.81 | 1172858.27 | 224.16 | BET      | 1607   | 601063.61 | 1173077.47 | 226.15 |         |
| 1525   | 600901.89 | 1172860.88 | 224.29 |          | 1608   | 601066.21 | 1173075.20 | 226.22 |         |
| 1526   | 600899.62 | 1172863.93 | 224.26 | AC       | 1609   | 601069.38 | 1173072.83 | 226.15 | BET     |
| 1527   | 600898.95 | 1172864.47 | 224.19 | VS       | 1610   | 601070.03 | 1173072.60 | 226.11 | HOR     |
| 1528   | 600898.04 | 1172865.35 | 223.96 |          | 1611   | 601071.29 | 1173071.73 | 225.52 |         |
| 1529   | 600911.76 | 1172883.35 | 224.19 |          | 1612   | 601082.91 | 1173086.61 | 225.53 |         |
| 1530   | 600913.49 | 1172883.30 | 224.55 | VS       | 1613   | 601081.32 | 1173087.04 | 226.09 | HOR     |
| 1531   | 600914.14 | 1172882.91 | 224.59 | AC       | 1614   | 601080.92 | 1173087.39 | 226.14 | BET     |
| 1532   | 600917.07 | 1172881.04 | 224.68 |          | 1615   | 601077.90 | 1173090.03 | 226.16 |         |
| 1533   | 600920.45 | 1172879.12 | 224.66 | BET      | 1616   | 601069.73 | 1173085.24 | 226.14 |         |
| 1534   | 600921.02 | 1172878.62 | 224.63 | HOR      | 1617   | 601069.20 | 1173085.56 | 226.07 | AC      |
| 1535   | 600921.87 | 1172877.94 | 224.23 |          | 1618   | 601074.96 | 1173092.61 | 226.06 | AC      |
| 1536   | 600938.48 | 1172899.65 | 224.43 |          | 1619   | 601064.49 | 1173092.82 | 225.57 | ZNACKA  |
| 1537   | 600937.48 | 1172900.52 | 224.94 | HOR      | 1620   | 601062.09 | 1173086.89 | 225.57 | XCES    |
| 1538   | 600936.89 | 1172901.26 | 224.98 | BET      | 1621   | 601064.43 | 1173086.31 | 225.71 | CES     |
| 1539   | 600934.28 | 1172903.69 | 225.04 |          | 1622   | 601063.94 | 1173084.01 | 225.82 | CES     |
| 1540   | 600931.64 | 1172905.88 | 224.98 | AC       | 1623   | 601067.01 | 1173083.27 | 226.03 | CES     |
| 1541   | 600931.16 | 1172906.55 | 224.96 | VS       | 1624   | 601068.78 | 1173087.84 | 225.94 | CES     |
| 1542   | 600930.03 | 1172908.08 | 224.66 |          | 1625   | 601069.88 | 1173087.62 | 226.02 | CES     |
| 1543   | 600942.95 | 1172926.40 | 224.81 |          | 1626   | 601070.67 | 1173090.92 | 225.93 | CES XVS |
| 1544   | 600945.09 | 1172925.62 | 225.15 | VS       | 1627   | 601068.37 | 1173091.48 | 225.78 | CES     |
| 1545   | 600945.82 | 1172925.16 | 225.18 | AC       | 1628   | 601066.08 | 1173091.26 | 225.67 | CES     |
| 1546   | 600948.92 | 1172923.27 | 225.19 |          | 1629   | 601065.49 | 1173089.62 | 225.67 | CES     |
| 1547   | 600952.40 | 1172921.40 | 225.22 | BET      | 1630   | 601062.61 | 1173090.26 | 225.50 | CES     |
| 1548   | 600952.98 | 1172920.93 | 225.17 | HOR      | 1631   | 601072.19 | 1173091.38 | 225.96 | VS      |
| 1549   | 600954.08 | 1172920.02 | 224.62 |          | 1632   | 601074.30 | 1173092.79 | 226.04 | VS      |
| 1550   | 600967.89 | 1172938.41 | 224.82 |          | 1633   | 601076.03 | 1173094.54 | 226.09 | VS      |
| 1551   | 600966.20 | 1172938.62 | 225.36 | HOR      | 1634   | 601074.68 | 1173095.61 | 225.69 |         |
| 1552   | 600965.30 | 1172938.58 | 225.37 | BET      | 1635   | 601076.75 | 1173094.62 | 226.11 | AC      |
| 1553   | 600962.70 | 1172941.38 | 225.45 |          | 1636   | 601088.87 | 1173109.78 | 226.09 | AC      |
| 1554   | 600960.46 | 1172943.98 | 225.36 | AC       | 1637   | 601088.43 | 1173110.16 | 226.11 | VS      |
| 1555   | 600959.89 | 1172944.50 | 225.36 | VS       | 1638   | 601087.35 | 1173111.47 | 225.68 |         |
| 1556   | 600958.46 | 1172945.41 | 225.01 |          | 1639   | 601092.16 | 1173108.17 | 226.11 |         |
| 1557   | 600977.59 | 1172970.76 | 225.33 |          | 1640   | 601095.53 | 1173105.89 | 226.07 | BET     |
| 1558   | 600979.46 | 1172970.32 | 225.67 | VS       | 1641   | 601095.99 | 1173105.57 | 226.05 | HOR     |
| 1559   | 600980.22 | 1172970.09 | 225.69 | AC       | 1642   | 601097.10 | 1173104.64 | 225.56 |         |
| 1560   | 600982.75 | 1172967.88 | 225.75 |          | 1643   | 601111.28 | 1173122.53 | 225.51 |         |
| 1561   | 600985.64 | 1172964.89 | 225.74 | BET      | 1644   | 601110.51 | 1173123.93 | 226.00 | HOR     |
| 1562   | 600986.68 | 1172963.63 | 225.27 |          | 1645   | 601110.05 | 1173124.54 | 226.03 | BET     |
| 1563   | 600986.51 | 1172965.10 | 225.73 | HOR      | 1646   | 601107.20 | 1173126.82 | 226.10 |         |
| 1564   | 601000.38 | 1172980.93 | 225.37 |          | 1647   | 601103.89 | 1173128.65 | 226.07 | AC      |
| 1565   | 600999.74 | 1172982.40 | 225.87 | HOR      | 1648   | 601103.10 | 1173129.02 | 226.03 | VS      |
| 1566   | 600999.26 | 1172983.19 | 225.91 | BET      | 1649   | 601115.89 | 1173144.86 | 226.06 | VS      |
| 1567   | 600996.43 | 1172985.56 | 225.94 |          | 1650   | 601114.80 | 1173146.21 | 225.56 |         |
| 1568   | 600994.01 | 1172988.13 | 225.90 | AC       | 1651   | 601117.04 | 1173145.29 | 226.05 | AC      |
| 1569   | 600993.54 | 1172988.79 | 225.92 | VS       | 1652   | 601120.16 | 1173143.34 | 226.06 |         |
| 1570   | 600992.37 | 1172990.17 | 225.60 |          | 1653   | 601123.77 | 1173141.52 | 226.03 | BET     |
| 1571   | 601005.18 | 1173007.04 | 225.71 |          | 1654   | 601124.33 | 1173141.05 | 226.01 | HOR     |
| 1572   | 601006.95 | 1173006.41 | 226.04 | VS       | 1655   | 601125.10 | 1173140.07 | 225.52 |         |
| 1573   | 601007.70 | 1173006.05 | 226.09 | AC       | 1656   | 601139.48 | 1173158.01 | 225.58 |         |
| 1574   | 601010.47 | 1173004.11 | 226.12 |          | 1657   | 601138.06 | 1173158.28 | 226.10 | HOR     |
| 1575   | 601012.95 | 1173001.16 | 226.06 | BET      | 1658   | 601137.42 | 1173158.67 | 226.10 | BET     |
| 1576   | 601013.90 | 1173001.21 | 226.01 | HOR      | 1659   | 601134.67 | 1173161.43 | 226.17 |         |
| 1577   | 601013.78 | 1173000.04 | 226.00 | ZNACKA   | 1660   | 601132.19 | 1173164.15 | 226.14 | AC      |

| č.bodu | Y         | X          | Z      | popis    | č.bodu | Y         | X          | Z      | popis |
|--------|-----------|------------|--------|----------|--------|-----------|------------|--------|-------|
| 1661   | 601131.71 | 1173164.74 | 226.13 | VS       | 1744   | 601276.08 | 1173331.76 | 225.61 | HOR   |
| 1662   | 601130.48 | 1173166.01 | 225.67 |          | 1745   | 601275.65 | 1173332.13 | 225.66 | BET   |
| 1663   | 601146.25 | 1173184.62 | 225.73 |          | 1746   | 601272.91 | 1173335.01 | 225.70 |       |
| 1664   | 601147.42 | 1173184.00 | 226.24 | VS       | 1747   | 601270.00 | 1173337.20 | 225.64 | AC    |
| 1665   | 601147.85 | 1173183.79 | 226.22 | AC       | 1748   | 601269.47 | 1173337.85 | 225.62 | VS    |
| 1666   | 601150.69 | 1173181.44 | 226.27 |          | 1749   | 601268.02 | 1173339.09 | 225.18 |       |
| 1667   | 601154.02 | 1173179.51 | 226.23 | BET      | 1750   | 601283.33 | 1173358.47 | 224.99 |       |
| 1668   | 601154.57 | 1173179.31 | 226.23 | HOR      | 1751   | 601285.25 | 1173357.48 | 225.45 | VS    |
| 1669   | 601155.67 | 1173178.32 | 225.74 |          | 1752   | 601286.06 | 1173357.28 | 225.48 | AC    |
| 1670   | 601171.52 | 1173197.78 | 225.84 |          | 1753   | 601288.49 | 1173354.56 | 225.56 |       |
| 1671   | 601170.87 | 1173199.22 | 226.33 | HOR      | 1754   | 601291.76 | 1173352.52 | 225.51 | BET   |
| 1672   | 601170.50 | 1173199.87 | 226.39 | BET      | 1755   | 601292.23 | 1173351.80 | 225.44 | HOR   |
| 1673   | 601167.48 | 1173202.48 | 226.43 |          | 1756   | 601293.23 | 1173350.88 | 224.95 |       |
| 1674   | 601165.06 | 1173205.28 | 226.40 | AC       | 1757   | 601310.12 | 1173371.54 | 224.82 |       |
| 1675   | 601164.84 | 1173206.02 | 226.42 | VS       | 1758   | 601309.55 | 1173373.61 | 225.38 | HOR   |
| 1676   | 601164.28 | 1173207.50 | 226.02 |          | 1759   | 601309.16 | 1173374.14 | 225.40 | BET   |
| 1677   | 601179.51 | 1173226.60 | 226.08 |          | 1760   | 601306.00 | 1173376.45 | 225.44 |       |
| 1678   | 601181.21 | 1173226.41 | 226.55 | VS       | 1761   | 601303.37 | 1173378.95 | 225.33 | AC    |
| 1679   | 601181.61 | 1173225.89 | 226.51 | AC       | 1762   | 601303.02 | 1173379.63 | 225.33 | VS    |
| 1680   | 601184.34 | 1173223.59 | 226.55 |          | 1763   | 601301.74 | 1173381.01 | 224.84 |       |
| 1681   | 601186.96 | 1173220.80 | 226.51 | BET      | 1764   | 601316.89 | 1173400.19 | 224.72 |       |
| 1682   | 601187.60 | 1173220.48 | 226.51 | HOR      | 1765   | 601319.01 | 1173399.74 | 225.24 | VS    |
| 1683   | 601188.78 | 1173219.73 | 226.01 |          | 1766   | 601320.11 | 1173399.83 | 225.29 | AC    |
| 1684   | 601205.53 | 1173242.83 | 226.45 | HOR      | 1767   | 601322.53 | 1173397.11 | 225.33 |       |
| 1685   | 601206.74 | 1173241.97 | 225.92 |          | 1768   | 601326.78 | 1173396.26 | 225.23 | BET   |
| 1686   | 601205.18 | 1173243.41 | 226.45 | BET      | 1769   | 601327.30 | 1173396.05 | 225.24 | HOR   |
| 1687   | 601202.28 | 1173246.10 | 226.48 |          | 1770   | 601328.87 | 1173395.01 | 224.74 |       |
| 1688   | 601199.81 | 1173248.72 | 226.44 | AC       | 1771   | 601344.72 | 1173415.07 | 224.64 |       |
| 1689   | 601199.50 | 1173249.06 | 226.53 | VS       | 1772   | 601343.18 | 1173415.66 | 225.18 | HOR   |
| 1690   | 601197.68 | 1173250.02 | 226.02 |          | 1773   | 601342.79 | 1173416.30 | 225.18 | BET   |
| 1691   | 601209.82 | 1173265.03 | 225.99 |          | 1774   | 601340.28 | 1173419.16 | 225.23 |       |
| 1692   | 601211.26 | 1173264.01 | 226.38 | VS       | 1775   | 601336.81 | 1173420.71 | 225.13 | AC    |
| 1693   | 601211.70 | 1173263.56 | 226.34 | AC       | 1776   | 601336.21 | 1173421.29 | 225.09 | VS    |
| 1694   | 601214.52 | 1173261.50 | 226.36 |          | 1777   | 601334.88 | 1173423.55 | 224.48 |       |
| 1695   | 601217.65 | 1173259.05 | 226.30 | BET      | 1778   | 601352.46 | 1173445.58 | 224.30 |       |
| 1696   | 601218.28 | 1173258.59 | 226.29 | HOR      | 1779   | 601355.00 | 1173444.87 | 224.98 | VS    |
| 1697   | 601219.24 | 1173257.67 | 225.93 |          | 1780   | 601355.77 | 1173444.54 | 225.04 | AC    |
| 1698   | 601214.89 | 1173267.81 | 226.29 | AC XNZP  | 1781   | 601358.93 | 1173442.57 | 225.08 |       |
| 1699   | 601216.09 | 1173271.39 | 226.17 | NZP      | 1782   | 601361.65 | 1173439.87 | 224.98 | BET   |
| 1700   | 601216.47 | 1173273.35 | 226.06 | NZP      | 1783   | 601362.27 | 1173439.51 | 224.95 | HOR   |
| 1701   | 601216.29 | 1173275.15 | 225.88 | NZP      | 1784   | 601363.64 | 1173438.80 | 224.51 |       |
| 1702   | 601215.02 | 1173276.37 | 225.65 | NZP      | 1785   | 601377.78 | 1173455.85 | 224.53 |       |
| 1703   | 601216.12 | 1173280.33 | 225.48 | XNZP     | 1786   | 601375.87 | 1173456.12 | 224.95 | HOR   |
| 1704   | 601218.51 | 1173280.10 | 225.70 | NZP      | 1787   | 601375.19 | 1173456.55 | 225.00 | BET   |
| 1705   | 601220.96 | 1173280.30 | 225.90 | NZP      | 1788   | 601372.22 | 1173459.09 | 225.03 |       |
| 1706   | 601222.94 | 1173280.87 | 225.89 | NZP      | 1789   | 601369.48 | 1173461.52 | 224.98 | AC    |
| 1707   | 601218.79 | 1173273.32 | 226.18 | AC       | 1790   | 601369.09 | 1173462.20 | 224.98 | VS    |
| 1708   | 601221.24 | 1173276.52 | 226.14 | AC       | 1791   | 601367.34 | 1173464.05 | 224.34 |       |
| 1709   | 601225.03 | 1173281.37 | 226.05 | AC       | 1792   | 601381.51 | 1173483.38 | 224.16 |       |
| 1710   | 601224.56 | 1173281.82 | 225.95 | AC       | 1793   | 601384.24 | 1173481.65 | 224.84 | VS    |
| 1711   | 601224.72 | 1173282.10 | 225.95 | NZP AC   | 1794   | 601385.99 | 1173482.45 | 224.89 | AC    |
| 1712   | 601226.65 | 1173282.97 | 226.05 | AC       | 1795   | 601388.65 | 1173479.90 | 224.93 |       |
| 1713   | 601226.03 | 1173283.84 | 225.95 | XVS      | 1796   | 601392.60 | 1173478.39 | 224.92 | BET   |
| 1714   | 601224.86 | 1173284.71 | 225.57 |          | 1797   | 601393.16 | 1173478.04 | 224.90 | HOR   |
| 1715   | 601221.67 | 1173282.55 | 225.53 |          | 1798   | 601394.30 | 1173477.03 | 224.45 |       |
| 1716   | 601229.56 | 1173280.52 | 226.13 |          | 1799   | 601409.92 | 1173496.34 | 224.44 |       |
| 1717   | 601224.54 | 1173265.84 | 226.13 | HOR      | 1800   | 601409.09 | 1173498.22 | 224.88 | HOR   |
| 1718   | 601225.99 | 1173265.88 | 225.84 |          | 1801   | 601408.73 | 1173499.03 | 224.89 | BET   |
| 1719   | 601226.46 | 1173269.87 | 226.16 | XNZP BET | 1802   | 601405.47 | 1173501.07 | 224.93 |       |
| 1720   | 601227.99 | 1173270.02 | 226.10 | NZP      | 1803   | 601403.61 | 1173504.27 | 224.92 | AC    |
| 1721   | 601230.46 | 1173270.23 | 226.03 | NZP      | 1804   | 601403.09 | 1173504.84 | 224.90 | VS    |
| 1722   | 601232.84 | 1173269.80 | 226.12 | NZP      | 1805   | 601402.07 | 1173506.55 | 224.41 |       |
| 1723   | 601235.28 | 1173272.41 | 226.22 | XNZP     | 1806   | 601415.68 | 1173525.01 | 224.11 |       |
| 1724   | 601234.16 | 1173273.99 | 226.14 | NZP      | 1807   | 601418.38 | 1173524.26 | 224.91 | VS    |
| 1725   | 601233.73 | 1173277.64 | 226.09 | NZP      | 1808   | 601418.93 | 1173523.77 | 224.95 | AC    |
| 1726   | 601233.45 | 1173279.15 | 226.08 | NZP BET  | 1809   | 601421.77 | 1173521.50 | 225.02 |       |
| 1727   | 601234.11 | 1173278.17 | 226.07 | XHOR     | 1810   | 601424.85 | 1173519.08 | 224.92 | BET   |
| 1728   | 601235.00 | 1173277.43 | 225.82 |          | 1811   | 601426.06 | 1173519.51 | 224.90 | HOR   |
| 1729   | 601248.80 | 1173295.04 | 225.38 |          | 1812   | 601428.49 | 1173520.08 | 224.41 |       |
| 1730   | 601246.89 | 1173295.04 | 225.81 | HOR      | 1813   | 601443.13 | 1173538.39 | 224.36 |       |
| 1731   | 601246.03 | 1173295.48 | 225.90 | BET      | 1814   | 601442.79 | 1173540.41 | 224.96 | HOR   |
| 1732   | 601243.61 | 1173298.19 | 225.95 |          | 1815   | 601443.10 | 1173541.85 | 225.04 | BET   |
| 1733   | 601241.07 | 1173301.02 | 225.90 | AC       | 1816   | 601440.01 | 1173544.50 | 225.10 |       |
| 1734   | 601240.51 | 1173301.47 | 225.88 | VS       | 1817   | 601437.70 | 1173547.34 | 225.01 | AC    |
| 1735   | 601239.11 | 1173302.73 | 225.34 |          | 1818   | 601438.02 | 1173548.96 | 225.03 | VS    |
| 1736   | 601255.04 | 1173322.64 | 225.30 |          | 1819   | 601436.58 | 1173550.40 | 224.50 |       |
| 1737   | 601257.06 | 1173322.18 | 225.71 | VS       | 1820   | 601453.07 | 1173571.76 | 224.63 |       |
| 1738   | 601257.54 | 1173321.67 | 225.74 | AC       | 1821   | 601454.93 | 1173570.31 | 225.08 | VS    |
| 1739   | 601260.59 | 1173319.67 | 225.78 |          | 1822   | 601455.67 | 1173570.21 | 225.12 | AC    |
| 1740   | 601264.30 | 1173318.11 | 225.74 | BET      | 1823   | 601458.38 | 1173567.78 | 225.17 |       |
| 1741   | 601264.85 | 1173317.75 | 225.75 | HOR      | 1824   | 601462.04 | 1173565.85 | 225.09 | BET   |
| 1742   | 601266.07 | 1173316.52 | 225.15 |          | 1825   | 601462.45 | 1173565.38 | 225.06 | HOR   |
| 1743   | 601277.89 | 1173331.44 | 225.08 |          | 1826   | 601463.93 | 1173564.49 | 224.46 |       |

| č.bodu | Y         | X          | Z      | popis  |
|--------|-----------|------------|--------|--------|
| 1827   | 601479.75 | 1173584.66 | 224.42 |        |
| 1828   | 601479.06 | 1173586.46 | 225.07 | HOR    |
| 1829   | 601478.84 | 1173587.18 | 225.12 | BET    |
| 1830   | 601476.14 | 1173590.05 | 225.14 |        |
| 1831   | 601473.66 | 1173592.82 | 225.05 | AC     |
| 1832   | 601473.23 | 1173593.58 | 225.00 | VS     |
| 1833   | 601471.82 | 1173595.34 | 224.43 |        |
| 1834   | 601482.92 | 1173609.22 | 224.33 |        |
| 1835   | 601485.32 | 1173608.74 | 224.92 | VS     |
| 1836   | 601485.95 | 1173608.24 | 224.95 | AC     |
| 1837   | 601488.81 | 1173605.83 | 225.02 |        |
| 1838   | 601491.96 | 1173603.37 | 224.98 | BET    |
| 1839   | 601492.43 | 1173603.03 | 224.96 | HOR    |
| 1840   | 601493.67 | 1173602.35 | 224.33 |        |
| 1841   | 601506.05 | 1173617.97 | 224.26 |        |
| 1842   | 601504.36 | 1173618.19 | 224.78 | HOR    |
| 1843   | 601503.57 | 1173618.39 | 224.85 | BET    |
| 1844   | 601500.85 | 1173621.18 | 224.91 |        |
| 1845   | 601497.73 | 1173623.16 | 224.86 | AC     |
| 1846   | 601497.99 | 1173624.53 | 224.84 | VS     |
| 1847   | 601497.01 | 1173626.88 | 224.23 |        |
| 1848   | 601512.07 | 1173646.85 | 224.07 | KRIZEK |
| 1849   | 601512.51 | 1173643.25 | 224.59 | VS     |
| 1850   | 601513.01 | 1173642.45 | 224.61 | AC     |
| 1851   | 601516.05 | 1173640.53 | 224.69 |        |
| 1852   | 601519.53 | 1173638.50 | 224.62 | BET    |
| 1853   | 601520.12 | 1173638.26 | 224.62 | HOR    |
| 1854   | 601521.90 | 1173637.76 | 224.04 |        |

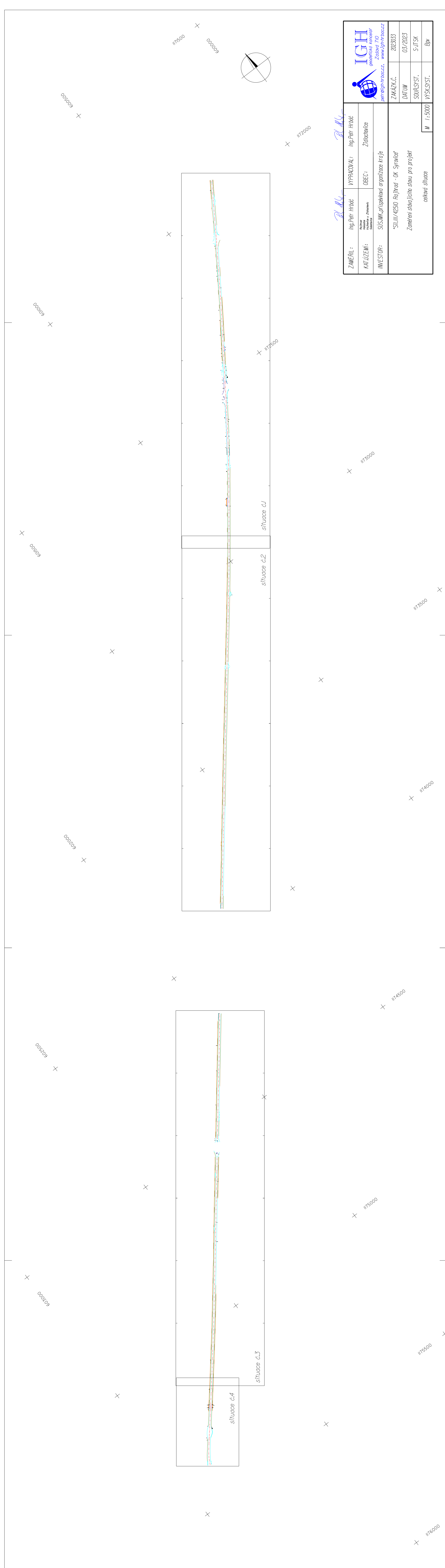
[illegible]



|   |  |                |                |   |
|---|--|----------------|----------------|---|
| ZNAČKA:   | Ing. pr. rinde                         | Ing. pr. rinde | Ing. pr. rinde |  <p><b>IGH</b><br/>posrednik v ročnem<br/>posredovanju<br/>www.igh-rb.si<br/>www.igh-rb.si</p> |
| KAZIVNIŠKA:   | Ing. pr.                               | Ing. pr.       | Zdelovane      |   |
| INVESTOR:   | SOSIS, priskrba in organizacija krogle |                |                |   |
|   | SLOVENIJA, Ing. pr. in Spolnik         |                |                |   |
| Zamena stolpnice stena na pragu                                       |  |                |                |   |
| Polnopravni vstopni projekti v vstopnem prostoru                      |  |                |                |   |
| <div> <div>11 / 14000</div> <div>19545571</div> <div>849</div> </div> |  |                |                |   |



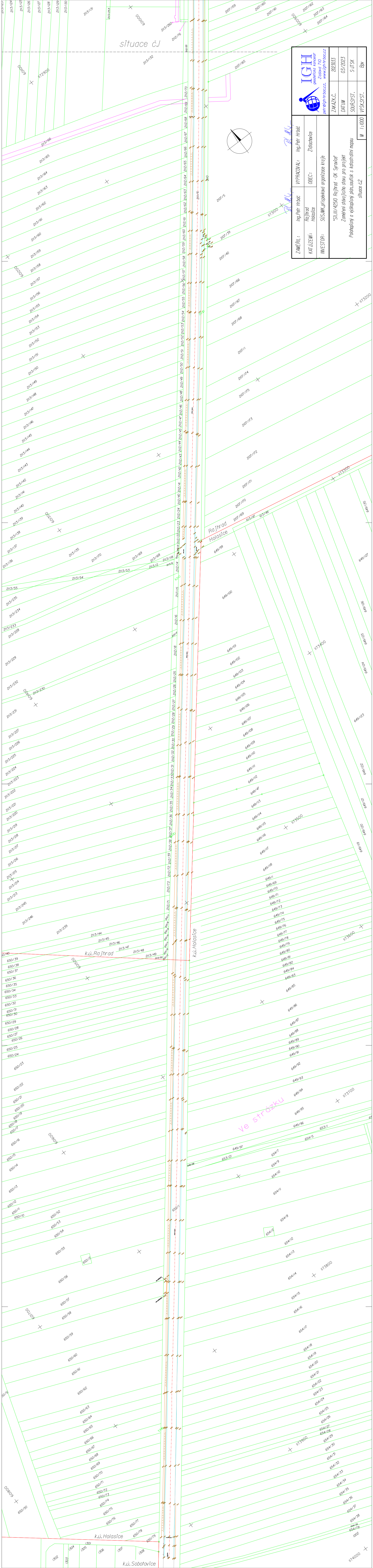

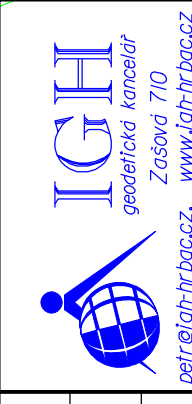
|   |                                  |                     |
|---|----------------------------------|---------------------|
| <br>Ing. Jaroslav Hájek<br>www.igh-hajek.cz | VYPRACOVANÉ: Ing. Jaroslav Hájek |                     |
|   | PROJEKTANT: Ing. Jaroslav Hájek  | ZADAVATEL: Záměrník |
|   | KATEGORIE: II. stupeň            | STAVBA: II. stupeň  |
| ZAMĚŘENÍ: SÚMĚRNÍKOVÝ PRŮŘEZ<br>Záměrník s úrovní a výškovými údaji<br>Projevy a výškovými údaji s měřítkem 1:500             | ZAMĚŘENÍ: SÚMĚRNÍKOVÝ PRŮŘEZ     |                     |
|   | DATUM: 03.2023                   |                     |
|   | VÝŠKA: 5.154                     |                     |
| MĚŘITEL: VYS. SÚM.  |                                  | 1:500               |



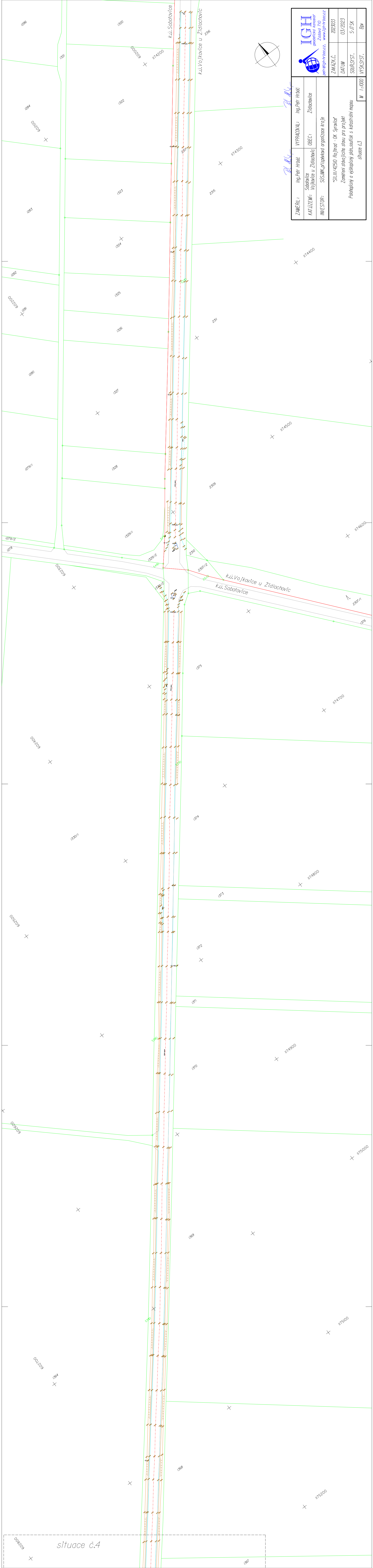

|           |                     |             |                     |
|-----------|---------------------|-------------|---------------------|
| ZÁKAZNÍK: | Stavby a inženýring | PROJEKTANT: | Stavby a inženýring |
| KONTAKT:  | Stavby a inženýring | PROJEKTANT: | Stavby a inženýring |
| INVESTOR: | Stavby a inženýring | PROJEKTANT: | Stavby a inženýring |
| ZÁKAZNÍK: | Stavby a inženýring | PROJEKTANT: | Stavby a inženýring |
| DATUM:    | 01/2023             | ZÁKAZNÍK:   | Stavby a inženýring |
| SOBĚS:    | Stavby a inženýring | PROJEKTANT: | Stavby a inženýring |
| STUPEŇ:   | Stavby a inženýring | PROJEKTANT: | Stavby a inženýring |
| AB        | 1:500               | W           | 1:500               |

P. Hrbáč

002800

situace č.3

×

002900

|   |  |                             |  |             |         |
|---|--|-----------------------------|--|-------------|---------|
| ZAMĚŘIL : Ing. Petr Hrbáč                       |  | VYPRACOVAL: Ing. Petr Hrbáč | <br><b>IGH</b><br>geodetická kancelář<br>Zašová 710<br>petr@igh-hrbac.cz, www.igh-hrbac.cz | ZAKÁZK.Č.   | 2023033 |
| KAT.ÚZEMÍ: Sobotovice                           |  | OBEC: Židlochovice          |  | DATUM       | 03/2023 |
| INVESTOR: SÚS JMK, příspěvková organizace kraje |  |                             |  | SOUŘ. SYST. | S-JTSK  |
|   |  |                             |  | VÝŠK. SYST. | Bpv     |
| situace č.4                                     |  |                             | M  | 1:1000      |         |

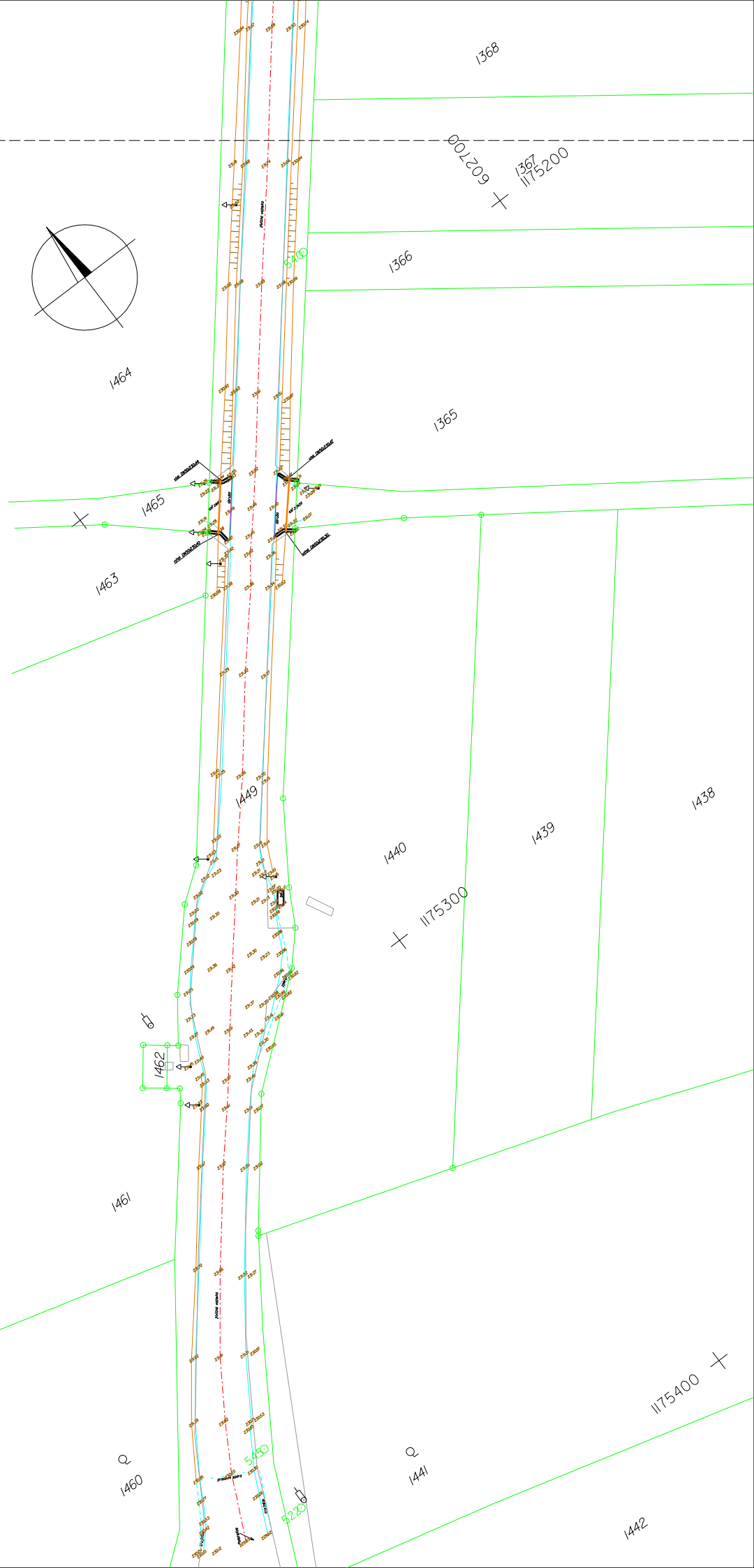
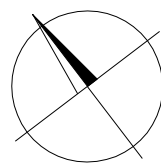

**Náležitosti a přesností odpovídá právním předpisům a podmínkám písemně  
dohodnutým s odběratelem.**

Ing. Petr Hrbáč  
oprávněn ověřovat výsledky zeměměřických činností  
dle § 13 odstavce 1 písmena c) zákona číslo 200/1994 Sbírky

Evidenční číslo ověření: 2545/11  
Ve Valašském Meziříčí dne: 27. 03. 2023

